



JET-Power, ALU-Power ja D-Power HM-jyrsimet



JET-Power. Erikoisjyrsin ruostu-
mattomille teräksille (alle HRc 45)



ALU-Power. Erikoisjyrsin alumiini-
lle ja kupariseoksille.



D-Power. Erikoisjyrsin grafiittia
varten.



JET-Power HM-jyrsimet

181-190

| | | | |
|--------|-----------------------------------------------------------------------------------|-----------------------|-----|
| EH 911 |  | 2-leikk., lyhyt | 181 |
| EH 830 |  | 3- ja 4-leikk., pitkä | 182 |
| EH 913 |  | 4-leikk., lyhyt | 183 |
| EH 915 |  | Monileikk., pitkä | 184 |
| EH 919 |  | Monileikk., HR pitkä | 185 |
| EH 921 |  | Monileikk., HR pitkä | 186 |

ALU-Power HM-jyrsimet

191-193

| | | | |
|--------|-------------------------------------------------------------------------------------|---------------------------|-----|
| E 5522 |  | 2-leikk., lyhyt | 191 |
| EG 909 |  | 2-leikk., nurkkap., lyhyt | 192 |
| EG 910 |  | 2-leikk., pallop., lyhyt | 193 |

D-Power HM-jyrsimet

194-196

| | | | |
|--------|-------------------------------------------------------------------------------------|-----------------------------|-----|
| EI 996 |  | 2-leikk., pienoisjyr. lyhyt | 194 |
| EI A13 |  | 3-leikk., nurkkap., lyhyt | 195 |
| EI 997 |  | 2-leikk., pienois., lyhyt | 196 |

Malli EH 911

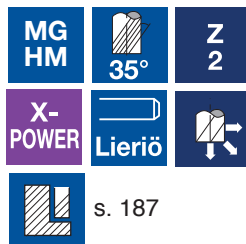

- Seosteräs, hiiliteräs, esikarkaistu teräs (alle HRC 45), ruostumattomat teräkset.

Toleranssiarvot, $\mu = 1/1000$ mm

| Ø mm | 1,0-3,0 | <3,0-6,0 | <6,0-10 | <10-18 | <18-30 |
|------|------------|------------|------------|------------|------------|
| e8 | -14 -28 | -20 -38 | -25 -47 | -32 -59 | -40 -73 |
| h6 | 0 -6 | 0 -8 | 0 -9 | 0 -11 | 0 -13 |

Vahvistettu
kärkileikkuu

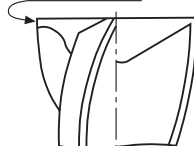

| Tuotenumro | Malli EH 911... | d1 e8 | L mm | l mm | d2 h6 | Hinta |
|------------|--------------------|----------|---------|---------|----------|---------------|
| 3865000 | ...010 | 1,0 | 40 | 2,5 | 4 | 24,10 |
| 3865001 | ...901 | 1,0 | 40 | 2,5 | 6 | 34,85 |
| 3865002 | ...015 | 1,5 | 40 | 4 | 4 | 24,10 |
| 3865003 | ...902 | 1,5 | 40 | 4 | 6 | 34,85 |
| 3865004 | ...020 | 2,0 | 40 | 6 | 4 | 21,95 |
| 3865005 | ...903 | 2,0 | 40 | 6 | 6 | 31,65 |
| 3865006 | ...025 | 2,5 | 40 | 8 | 4 | 21,95 |
| 3865007 | ...904 | 2,5 | 40 | 8 | 6 | 31,65 |
| 3865008 | ...030 | 3,0 | 45 | 8 | 6 | 31,65 |
| 3865010 | ...040 | 4,0 | 45 | 11 | 6 | 31,65 |
| 3865012 | ...050 | 5,0 | 50 | 13 | 6 | 31,65 |
| 3865014 | ...060 | 6,0 | 50 | 13 | 6 | 31,65 |
| 3865016 | ...070 | 7,0 | 60 | 16 | 8 | 40,60 |
| 3865018 | ...080 | 8,0 | 60 | 19 | 8 | 40,60 |
| 3865020 | ...090 | 9,0 | 70 | 19 | 10 | 60,10 |
| 3865022 | ...100 | 10,0 | 70 | 22 | 10 | 60,10 |
| 3865024 | ...110 | 11,0 | 75 | 22 | 12 | 82,50 |
| 3865026 | ...120 | 12,0 | 75 | 26 | 12 | 82,50 |
| 3865028 | ...140 | 14,0 | 85 | 26 | 16 | 136,50 |
| 3865030 | ...160 | 16,0 | 100 | 32 | 16 | 136,50 |
| 3865032 | ...180 | 18,0 | 100 | 32 | 16 | 182,00 |
| 3865034 | ...200 | 20,0 | 105 | 38 | 20 | 227,00 |
| 3865037 | ...220 | 22,0 | 105 | 38 | 20 | 295,00 |
| 3865040 | ...250 | 25,0 | 120 | 45 | 25 | 362,00 |

Malli EH 830



- Seosteräs, hiiliateräs, esikarkaistu teräs (alle HRc 45), ruostumattomat teräkset.

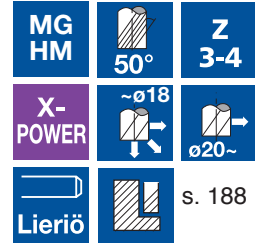

s. 188

Toleranssiarvot, $\mu = 1/1000$ mm

| Ø mm | 1,0-3,0 | <3,0-6,0 | <6,0-10 | <10-18 | <18-30 |
|------|------------|------------|------------|------------|------------|
| e8 | -14 -28 | -20 -38 | -25 -47 | -32 -59 | -40 -73 |
| h6 | 0 -6 | 0 -8 | 0 -9 | 0 -11 | 0 -13 |

Vahvistettu
kärkileikkuu

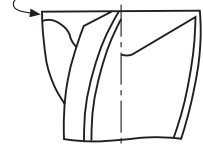

| Tuotenro | Malli EH 830... | d1 e8 | L mm | l mm | Z | d2 h6 | Hinta |
|----------|--------------------|----------|---------|---------|---|----------|---------------|
| 3865090 | ...060 | 6,0 | 50 | 13 | 3 | 6 | 41,20 |
| 3865092 | ...080 | 8,0 | 60 | 19 | 3 | 8 | 52,70 |
| 3865094 | ...100 | 10,0 | 70 | 22 | 3 | 10 | 78,10 |
| 3865096 | ...120 | 12,0 | 75 | 25 | 3 | 12 | 107,50 |
| 3865100 | ...160 | 16,0 | 90 | 32 | 3 | 16 | 177,50 |
| 3865102 | ...901 | 18,0 | 90 | 32 | 3 | 16 | 259,00 |
| 3865103 | ...180 | 18,0 | 90 | 32 | 3 | 18 | 259,00 |
| 3865105 | ...200 | 20,0 | 100 | 38 | 4 | 20 | 295,00 |
| 3865110 | ...250 | 25,0 | 120 | 45 | 4 | 25 | 471,00 |

Malli EH 913

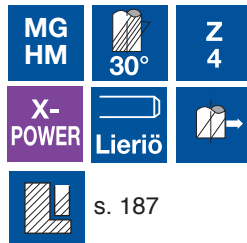

- Seosteräs, hiilliteräs, esikarkaistu teräs (alle HRc 45), ruostumattomat teräksset.

s. 187

Toleranssiarvot, $\mu = 1/1000$ mm

| Ø mm | 1,0-3,0 | <3,0-6,0 | <6,0-10 | <10-18 | <18-30 |
|------|------------|------------|------------|------------|------------|
| e8 | -14 -28 | -20 -38 | -25 -47 | -32 -59 | -40 -73 |
| h6 | 0 -6 | 0 -8 | 0 -9 | 0 -11 | 0 -13 |







| Tuotenro | Malli EH 913... | d1 e8 | L mm | l mm | d2 h6 | Hinta |
|----------|--------------------|----------|---------|---------|----------|--------|
| 3865050 | ...020 | 2,0 | 40 | 6 | 4 | 21,55 |
| 3865051 | ...901 | 2,0 | 40 | 6 | 6 | 31,65 |
| 3865052 | ...025 | 2,5 | 40 | 8 | 4 | 21,95 |
| 3865053 | ...902 | 2,5 | 40 | 8 | 6 | 31,65 |
| 3865054 | ...030 | 3,0 | 45 | 8 | 6 | 31,65 |
| 3865056 | ...040 | 4,0 | 45 | 11 | 6 | 31,65 |
| 3865058 | ...050 | 5,0 | 50 | 13 | 6 | 31,65 |
| 3865060 | ...060 | 6,0 | 50 | 13 | 6 | 31,65 |
| 3865062 | ...070 | 7,0 | 60 | 16 | 8 | 40,60 |
| 3865064 | ...080 | 8,0 | 60 | 19 | 8 | 40,60 |
| 3865066 | ...090 | 9,0 | 70 | 19 | 10 | 60,10 |
| 3865068 | ...100 | 10,0 | 70 | 22 | 10 | 60,10 |
| 3865070 | ...120 | 12,0 | 75 | 26 | 12 | 82,40 |
| 3865072 | ...140 | 14,0 | 85 | 26 | 16 | 136,50 |
| 3865074 | ...160 | 16,0 | 100 | 32 | 16 | 136,50 |
| 3865076 | ...180 | 18,0 | 100 | 32 | 16 | 182,00 |
| 3865078 | ...200 | 20,0 | 105 | 38 | 20 | 227,00 |
| 3865080 | ...220 | 22,0 | 105 | 38 | 20 | 295,00 |
| 3865085 | ...250 | 25,0 | 120 | 45 | 25 | 362,00 |

Malli EH 915



- Seosteräs, hiilliteräs, esikarkaistu teräs (alle HRc 45), ruostumattomat teräksset.

| | | |
|-----------------------------------------------------------------------------------|---------------------------------------------------------------------------------------------|------------------------------------------------------------------------------------|
| MG HM |  45° | Z 6-8 |
| X- POWER |  Lierio |  |
|  | s. 189 | |

**POSITIIVINEN
RINTAKULMA!**

Toleranssiarvot, $\mu = 1/1000$ mm

| \emptyset mm | 1,0-3,0 | <3,0-6,0 | <6,0-10 | <10-18 | <18-30 |
|----------------|------------|------------|------------|------------|------------|
| e8 | -14 -28 | -20 -38 | -25 -47 | -32 -59 | -40 -73 |
| h6 | 0 -6 | 0 -8 | 0 -9 | 0 -11 | 0 -13 |



| Tuotenro | Malli EH 915... | d1 e8 | L mm | l mm | Z | d2 h6 | Hinta |
|----------|--------------------|----------|---------|---------|---|----------|---------------|
| 3865120 | ...060 | 6,0 | 57 | 13 | 6 | 6 | 37,15 |
| 3865122 | ...080 | 8,0 | 63 | 19 | 6 | 8 | 47,00 |
| 3865124 | ...100 | 10,0 | 72 | 22 | 6 | 10 | 70,40 |
| 3865126 | ...120 | 12,0 | 83 | 26 | 6 | 12 | 95,70 |
| 3865128 | ...140 | 14,0 | 83 | 26 | 6 | 14 | 119,50 |
| 3865130 | ...160 | 16,0 | 92 | 32 | 6 | 16 | 160,50 |
| 3865133 | ...180 | 18,0 | 92 | 32 | 8 | 18 | 188,00 |
| 3865135 | ...200 | 20,0 | 104 | 38 | 8 | 20 | 236,00 |
| 3865140 | ...250 | 25,0 | 104 | 44 | 8 | 25 | 417,00 |

Malli EH 919

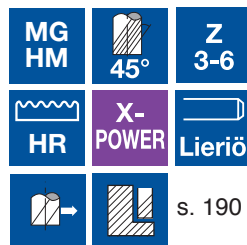

- Seosteräs, hiiliteräs, esikarkaistu teräs (alle HRC 45), ruostumattomat teräkset.

Vahvistettu
kärkileikkuu

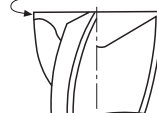

Toleranssiarvot, $\mu = 1/1000$ mm

| Ø mm | 1,0-3,0 | <3,0-6,0 | <6,0-10 | <10-18 | <18-30 |
|------|----------|----------|----------|----------|----------|
| h10 | 0 -40 | 0 -48 | 0 -58 | 0 -70 | 0 -84 |
| h6 | 0 -6 | 0 -8 | 0 -9 | 0 -11 | 0 -13 |

| Tuotenumero | Malli EH 919... | d1 h10 | l3 mm | l1 mm | Z | d2 h6 | Hinta |
|-------------|--------------------|-----------|----------|----------|---|----------|---------------|
| 3865240 | ...040 | 4 | 57 | 11 | 3 | 6 | 42,10 |
| 3865241 | ...050 | 5 | 57 | 13 | 4 | 6 | 42,10 |
| 3865242 | ...060 | 6 | 57 | 16 | 4 | 6 | 42,10 |
| 3865244 | ...080 | 8 | 63 | 16 | 4 | 8 | 49,35 |
| 3865246 | ...100 | 10 | 72 | 22 | 4 | 10 | 73,60 |
| 3865248 | ...120 | 12 | 83 | 26 | 4 | 12 | 94,60 |
| 3865250 | ...140 | 14 | 83 | 26 | 5 | 14 | 115,00 |
| 3865252 | ...160 | 16 | 92 | 32 | 5 | 16 | 154,50 |
| 3865255 | ...200 | 20 | 104 | 38 | 6 | 20 | 249,00 |
| 3865260 | ...250 | 25 | 121 | 45 | 6 | 25 | 436,00 |

Malli EH 921

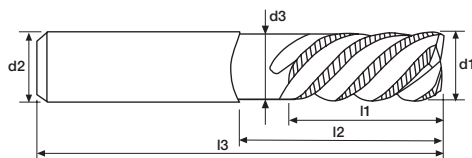

- Seosteräs, hiiliteräs, esikarkaistu teräs (alle HRC 45), ruostumattomat teräokset.



**PITKÄ
ULOTTUVUUS!**



Toleranssiarvot, $\mu = 1/1000$ mm

| Ø mm | 1,0-3,0 | <3,0-6,0 | <6,0-10 | <10-18 | <18-30 |
|------|----------|----------|----------|----------|----------|
| h10 | 0 -40 | 0 -48 | 0 -58 | 0 -70 | 0 -84 |
| h6 | 0 -6 | 0 -8 | 0 -9 | 0 -11 | 0 -13 |

| Tuotenro | Malli EH 921... | d1 h10 | l3 mm | l1 mm | l2 mm | d3 mm | Z | d2 h6 | Hinta |
|----------|--------------------|-----------|----------|----------|----------|----------|---|----------|---------------|
| 3865270 | ...060 | 6 | 57 | 16 | 20 | 5,5 | 4 | 6 | 50,60 |
| 3865272 | ...080 | 8 | 63 | 16 | 26 | 7,5 | 4 | 8 | 59,10 |
| 3865274 | ...100 | 10 | 72 | 22 | 31 | 9,5 | 4 | 10 | 88,40 |
| 3865276 | ...120 | 12 | 83 | 26 | 37 | 11,5 | 4 | 12 | 113,50 |
| 3865280 | ...160 | 16 | 100 | 32 | 51 | 15,5 | 5 | 16 | 185,00 |
| 3865285 | ...200 | 20 | 110 | 38 | 59 | 19,2 | 6 | 20 | 298,00 |

Malli EH 911

2-leikkuinen, lyhyt, urajyrsintä

| Materiaali | Hiiliteräs Seosteräs Työkaluteräs | Hiiliteräs Seosteräs Työkaluteräs | Ruostumaton teräs Seostitaani |
|---------------------------|-------------------------------------------------|---------------------------------------------------------|-------------------------------------|
| Kovuus Vetolujuus Ø | ~HRc30 ~1000 N/mm ² RPM Syöttö | HRc30-HRc45 1000~1500N/mm ² RPM Syöttö | RPM Syöttö |
| 2 | 9250 190 | 6050 120 | 5050 90 |
| 3 | 7150 210 | 4450 140 | 3700 120 |
| 4 | 6050 300 | 3700 180 | 3100 150 |
| 5 | 5050 320 | 3020 190 | 2530 160 |
| 6 | 4450 350 | 2690 220 | 2270 180 |
| 8 | 3360 380 | 2020 200 | 1680 180 |
| 10 | 2600 330 | 1600 160 | 1350 160 |
| 12 | 2200 280 | 1350 130 | 1090 130 |
| 16 | 1760 220 | 1090 110 | 850 110 |
| 20 | 1350 170 | 850 80 | 670 80 |
| 25 | 1090 130 | 670 70 | 550 60 |

RPM = kierrokset/min
Syöttö = mm/min

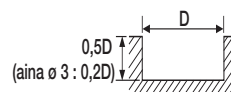

(aina Ø 3:0,2D)

Malli EH 913

4-leikkuinen, lyhyt, sivujyrsintä

| Materiaali | Hiiliteräs Seosteräs Työkaluteräs | Hiiliteräs Seosteräs Työkaluteräs | Ruostumaton teräs Seostitaani |
|---------------------------|-------------------------------------------------|---------------------------------------------------------|-------------------------------------|
| Kovuus Vetolujuus Ø | ~HRc30 ~1000 N/mm ² RPM Syöttö | HRc30-HRc45 1000~1500N/mm ² RPM Syöttö | RPM Syöttö |
| 2 | 9250 280 | 6050 170 | 5050 140 |
| 3 | 7150 320 | 4450 200 | 3700 170 |
| 4 | 6050 570 | 3700 350 | 3100 280 |
| 5 | 5050 600 | 3020 360 | 2530 300 |
| 6 | 4450 660 | 2690 410 | 2270 330 |
| 8 | 3360 710 | 2020 380 | 1680 350 |
| 10 | 2600 610 | 1600 300 | 1350 300 |
| 12 | 2200 520 | 1350 250 | 1090 240 |
| 16 | 1760 410 | 1090 200 | 850 200 |
| 20 | 1350 320 | 850 160 | 670 150 |
| 25 | 1090 250 | 670 130 | 550 120 |

RPM = kierrokset/min
Syöttö = mm/min

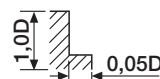

3- ja 4-leikkuinen, 50° nousu, urajyrshintä

| Materiaali | Hiiliteräs Seosteräs Työkaluteräs | Hiiliteräs Seosteräs Työkaluteräs | Ruostumaton teräs Seostitaani | Inconel |
|---------------------------|------------------------------------------------|---------------------------------------------------------|-------------------------------------|------------|
| Kovuus Vetolujuus Ø | ~HRC30 1000 N/mm ² RPM Syöttö | HRC30-HRC45 1000~1500N/mm ² RPM Syöttö | RPM Syöttö | RPM Syöttö |
| 6 | 5560 310 | 3360 200 | 2840 160 | 1160 40 |
| 8 | 4200 340 | 2520 180 | 2100 160 | 840 40 |
| 10 | 3260 300 | 2000 140 | 1680 140 | 670 40 |
| 12 | 2740 250 | 1680 120 | 1370 120 | 560 30 |
| 16 | 2200 200 | 1360 100 | 1050 100 | 420 25 |
| 18 | 1940 175 | 1210 85 | 950 85 | 370 20 |
| 20 | 1680 150 | 1060 70 | 840 70 | 320 20 |
| 25 | 1360 115 | 840 60 | 670 60 | 270 15 |

RPM = kierrokset/min
Syöttö = mm/min

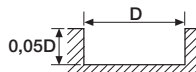
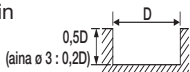

3- ja 4-leikkuinen, 50° nousu, sivujyrshintä

| Materiaali | Hiiliteräs Seosteräs Työkaluteräs | Hiiliteräs Seosteräs Työkaluteräs | Ruostumaton teräs Seostitaani | Inconel |
|---------------------------|------------------------------------------------|---------------------------------------------------------|-------------------------------------|------------|
| Kovuus Vetolujuus Ø | ~HRC30 1000 N/mm ² RPM Syöttö | HRC30-HRC45 1000~1500N/mm ² RPM Syöttö | RPM Syöttö | RPM Syöttö |
| 6 | 5560 400 | 3360 250 | 2840 250 | 1050 55 |
| 8 | 4200 420 | 2520 230 | 2100 265 | 840 50 |
| 10 | 3260 370 | 2000 180 | 1680 230 | 680 50 |
| 12 | 2740 310 | 1680 150 | 560 180 | 560 45 |
| 16 | 2200 250 | 1360 120 | 420 150 | 420 35 |
| 18 | 1940 220 | 1210 110 | 370 130 | 370 30 |
| 20 | 1680 190 | 1060 95 | 340 115 | 340 30 |
| 25 | 1360 150 | 840 75 | 270 90 | 270 25 |

RPM = kierrokset/min
Syöttö = mm/min



6- ja 8-leikkuinen, 45° nousu, pitkä, sivujyrsintä

| Materiaali | Hiiliteräs Seosteräs Työkaluteräs | Hiiliteräs Seosteräs Työkaluteräs | Ruostumaton teräs Seostitaani | Inconel |
|---------------------------|------------------------------------------------|---------------------------------------------------------|-------------------------------------|------------|
| Kovuus Vetolujuus Ø | ~HRC30 1000 N/mm ² RPM Syöttö | HRC30-HRC45 1000~1500N/mm ² RPM Syöttö | RPM Syöttö | RPM Syöttö |
| 6 | 5560 2000 | 3880 1370 | 3370 1100 | 1350 280 |
| 7 | 4880 2000 | 3410 1370 | 2930 1100 | 1170 280 |
| 8 | 4200 2000 | 2940 1370 | 2490 1100 | 1000 280 |
| 9 | 3780 2000 | 2630 1370 | 2200 1100 | 720 280 |
| 10 | 3360 2000 | 2320 1370 | 1920 1100 | 440 280 |
| 12 | 2840 1680 | 2000 1160 | 1610 1000 | 400 250 |
| 14 | 2470 1470 | 1740 1020 | 1380 885 | 355 220 |
| 16 | 2100 1260 | 1480 880 | 1160 770 | 310 190 |
| 20 | 1890 1130 | 1320 785 | 1030 695 | 280 170 |
| 25 | 1680 1010 | 1160 690 | 900 620 | 250 155 |
| 25 | 1500 900 | 1100 600 | 850 540 | 220 135 |

RPM =

kierrokset/min

Syöttö =

mm/min



6- ja 8-leikkuinen, 45° nousu, pitkä, sivujyrsintä, suurnopeustyöstö

| Materiaali | Hiiliteräs Seosteräs Työkaluteräs | Hiiliteräs Seosteräs Työkaluteräs |
|---------------------------|------------------------------------------------|---------------------------------------------------------|
| Kovuus Vetolujuus Ø | ~HRC30 1000 N/mm ² RPM Syöttö | HRC30-HRC45 1000~1500N/mm ² RPM Syöttö |
| 6 | 22200 8000 | 16800 6090 |
| 7 | 19500 8000 | 14700 6090 |
| 8 | 16800 8000 | 12600 6090 |
| 9 | 15100 8000 | 11300 6040 |
| 10 | 13400 8000 | 9980 5990 |
| 12 | 11350 6720 | 8400 5040 |
| 14 | 9850 5880 | 7350 4400 |
| 16 | 8400 5040 | 6300 3780 |
| 20 | 7550 4540 | 5670 3400 |
| 25 | 6700 4040 | 5040 3050 |
| 25 | 6000 3600 | 4500 2700 |

RPM = kierrokset/min

Syöttö = mm/min

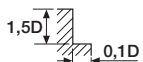

| Materiaali | Hiiliteräs Seosteräs Työkaluteräs | Hiiliteräs Seosteräs Työkaluteräs | Ruostumaton teräs Seostitaani | Inconel |
|---------------------------|------------------------------------------------|---------------------------------------------------------|-------------------------------------|------------|
| Kovuus Vetolujuus Ø | ~HRc30 1000 N/mm ² RPM Syöttö | HRc30-HRc45 1000~1500N/mm ² RPM Syöttö | RPM Syöttö | RPM Syöttö |
| 6 | 15600 2320 | 12400 840 | 8400 570 | 2400 190 |
| 8 | 11600 2320 | 9200 840 | 6300 570 | 1800 180 |
| 10 | 9200 2320 | 7600 840 | 5100 570 | 1300 190 |
| 12 | 8000 2400 | 6000 800 | 4200 570 | 1200 190 |
| 14 | 6800 2400 | 5200 840 | 3600 570 | 900 130 |
| 16 | 6000 2400 | 4800 760 | 3300 510 | 800 110 |
| 18 | 5200 2320 | 4400 720 | 2700 420 | 700 100 |
| 20 | 4800 2160 | 3600 560 | 2400 360 | 660 100 |
| 25 | 4300 2150 | 3200 620 | 2160 410 | 600 100 |

RPM =
kierrokset/min
Syöttö =
mm/min

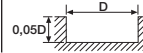
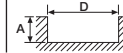
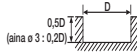

A: ø 6 - ø 10:0,25xD
ø 12 - ø 16:0,15xD
ø 18 - ø 25:0,10xD

Monileikkuinen, rouhinta, sivujyrsintä

| Materiaali | Hiiliteräs Seosteräs Työkaluteräs | Hiiliteräs Seosteräs Työkaluteräs | Ruostumaton teräs Seostitaani | Inconel |
|---------------------------|------------------------------------------------|---------------------------------------------------------|-------------------------------------|------------|
| Kovuus Vetolujuus Ø | ~HRc30 1000 N/mm ² RPM Syöttö | HRc30-HRc45 1000~1500N/mm ² RPM Syöttö | RPM Syöttö | RPM Syöttö |
| 6 | 15600 2320 | 12400 840 | 8400 570 | 2400 190 |
| 8 | 11600 2320 | 9200 840 | 6300 570 | 1800 180 |
| 10 | 9200 2320 | 7600 840 | 5100 570 | 1300 190 |
| 12 | 8000 2400 | 6000 800 | 4200 570 | 1200 190 |
| 14 | 6800 2400 | 5200 840 | 3600 570 | 900 130 |
| 16 | 6000 2400 | 4800 760 | 3300 510 | 800 110 |
| 18 | 5200 2320 | 4400 720 | 2700 420 | 700 100 |
| 20 | 4800 2160 | 3600 560 | 2400 360 | 660 100 |
| 25 | 4300 2150 | 3200 620 | 2160 410 | 600 100 |

RPM =
kierrokset/min
Syöttö =
mm/min

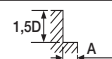

A: ø 6 - ø 10:0,15xD
ø 12 - ø 16:0,10xD
ø 18 - ø 25:0,05xD

Malli E 5522

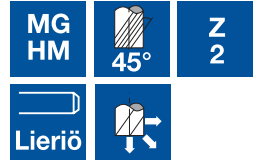

Toleranssiarvot, $\mu\text{m} = 1/1000 \text{ mm}$

| $\varnothing \text{ mm}$ | 1,0-3,0 | <3,0-6,0 | <6,0-10 | <10-18 | <18-30 |
|--------------------------|----------|----------|----------|----------|----------|
| h10 | 0 -40 | 0 -48 | 0 -58 | 0 -70 | 0 -84 |
| h6 | 0 -6 | 0 -8 | 0 -9 | 0 -11 | 0 -13 |

| Tuotenro | Malli E 5522... | d1 h10 | L mm | l mm | d2 h6 | Hinta |
|----------|-----------------|--------|------|------|-------|--------|
| 3865640 | ...030 | 3 | 57 | 8 | 6 | 14,73 |
| 3865641 | ...040 | 4 | 57 | 11 | 6 | 20,05 |
| 3865642 | ...050 | 5 | 57 | 13 | 6 | 20,05 |
| 3865643 | ...060 | 6 | 57 | 13 | 6 | 20,05 |
| 3865644 | ...080 | 8 | 63 | 19 | 8 | 32,15 |
| 3865645 | ...100 | 10 | 72 | 22 | 10 | 48,40 |
| 3865646 | ...120 | 12 | 83 | 26 | 12 | 67,80 |
| 3865647 | ...140 | 14 | 83 | 26 | 14 | 92,40 |
| 3865648 | ...160 | 16 | 92 | 32 | 16 | 116,50 |
| 3865649 | ...180 | 18 | 92 | 32 | 18 | 151,50 |
| 3865650 | ...200 | 20 | 104 | 38 | 20 | 196,50 |

Työstöarvosuositus

| \varnothing | Alumiini ja alumiiniseos | | | |
|---------------|--------------------------|------|------------|------|
| | RPM Syöttö | | RPM Syöttö | |
| 3 | 10000 | 700 | 10000 | 900 |
| 4 | 10000 | 900 | 10000 | 1100 |
| 5 | 10000 | 1000 | 10000 | 1300 |
| 6 | 10000 | 1200 | 10000 | 1500 |
| 8 | 8000 | 1400 | 8000 | 1800 |
| 10 | 8000 | 1700 | 8000 | 2100 |
| 12 | 8000 | 2100 | 8000 | 2600 |
| 14 | 6000 | 1800 | 6000 | 2200 |
| 16 | 6000 | 1900 | 6000 | 2400 |
| 18 | 4000 | 1400 | 4000 | 1800 |
| 20 | 4000 | 1600 | 4000 | 1900 |

RPM = kierrokset/min
Syöttö = mm/min

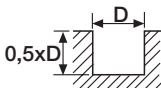

A: $\varnothing 3 \sim \varnothing 10 = 0,25D$
 $\varnothing 12 \sim \varnothing 20 = 0,5D$

Malli EG 909

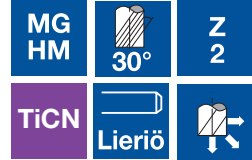

Toleranssiarvot, $\mu = 1/1000$ mm

| \varnothing mm | 1,0-3,0 | <3,0-6,0 | <6,0-10 | <10-18 | <18-30 |
|------------------|------------------|------------------|------------------|------------------|------------------|
| e8 | -0,014 -0,028 | -0,020 -0,038 | -0,025 -0,047 | -0,032 -0,059 | -0,040 -0,073 |
| h6 | 0 -6 | 0 -8 | 0 -9 | 0 -11 | 0 -13 |

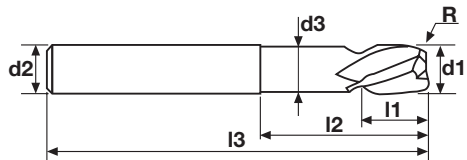

| Tuotenro | d1 mm | R $\pm 0,01$ | l1 mm | l2 mm | l3 mm | d3 mm | d2 mm | Hinta |
|----------|-------|--------------|-------|-------|-------|-------|-------|--------|
| 3865600 | 4,0 | R0,3 | 5 | 10 | 50 | 3,6 | 6 | 27,65 |
| 3865603 | 6,0 | R0,5 | 8 | 20 | 60 | 5,4 | 6 | 27,65 |
| 3865605 | 8,0 | R0,6 | 10 | 30 | 70 | 7,2 | 8 | 38,40 |
| 3865607 | 10,0 | R0,8 | 12 | 36 | 80 | 9,0 | 10 | 57,60 |
| 3865609 | 12,0 | R1,0 | 14 | 40 | 90 | 11,0 | 12 | 89,50 |
| 3865613 | 16,0 | R1,3 | 18 | 45 | 100 | 14,5 | 16 | 142,00 |
| 3865616 | 20,0 | R1,6 | 24 | 45 | 100 | 18,0 | 20 | 226,00 |

Työstöarvosuositus

2-leikkuinen, nurkkapyörästys, alumiinia varten, TiCN-pinnoite

| Materiaali | Alumiini Alumiiniseos | | | | Kupariseos | | | |
|------------|--------------------------|------|--------|------|------------|-----|--------|-----|
| | \varnothing mm | RPM | Syöttö | RPM | Syöttö | RPM | Syöttö | RPM |
| R0,3x 4 | 13000 | 1200 | 13000 | 1400 | 3900 | 300 | 3900 | 350 |
| R0,5x 6 | 13000 | 1500 | 13000 | 2000 | 3900 | 380 | 3900 | 500 |
| R0,6x 8 | 10000 | 1800 | 10000 | 2300 | 3000 | 450 | 3000 | 580 |
| R0,8x10 | 10000 | 2200 | 10000 | 2700 | 3000 | 550 | 3000 | 680 |
| R1,0x12 | 10000 | 2700 | 10000 | 3400 | 3000 | 680 | 3000 | 850 |
| R1,3x16 | 8000 | 2500 | 8000 | 3100 | 2400 | 630 | 2400 | 780 |
| R1,6x20 | 5000 | 2000 | 5000 | 2500 | 1500 | 500 | 1500 | 630 |

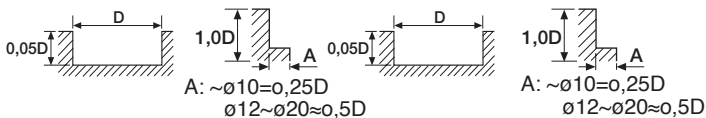

Malli EG 910

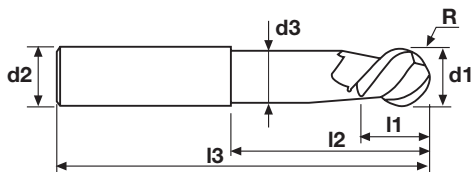
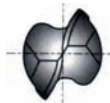

| Toleranssit | |
|-------------|-------|
| Jyrsin Ø | ±0,02 |
| Varsi Ø | h6 |

| Tuotenro | d1 mm | R ± 0,01 | l1 mm | l2 mm | l3 mm | d3 mm | d2 mm | Hinta |
|----------|----------|-------------|----------|----------|----------|----------|----------|---------------|
| 3865620 | 6,0 | R 3,0 | 5,5 | 25 | 55 | 5,4 | 6 | 29,55 |
| 3865623 | 8,0 | R 4,0 | 7 | 30 | 65 | 7,2 | 8 | 46,45 |
| 3865626 | 10,0 | R 5,0 | 8,5 | 35 | 75 | 9,0 | 10 | 68,75 |
| 3865630 | 12,0 | R 6,0 | 10,5 | 40 | 75 | 11,0 | 12 | 88,75 |
| 3865633 | 16,0 | R 8,0 | 14 | 50 | 90 | 14,5 | 16 | 147,50 |
| 3865636 | 20,0 | R10,0 | 17 | 50 | 100 | 18,0 | 20 | 213,00 |

Työstöarvosuositus

2-leikkuinen, pallopäinen, TiCN-pinnoite

| Materiaali | Alumiini Alumiiniseos | | Kupariseos | |
|------------|--------------------------|--------|------------|--------|
| | RPM | Syöttö | RPM | Syöttö |
| R3,0x 6 | 18000 | 1750 | 5500 | 440 |
| R4,0x 8 | 14000 | 2000 | 4200 | 500 |
| R5,0x10 | 14000 | 2350 | 4200 | 580 |
| R6,0x12 | 14000 | 3000 | 4200 | 750 |
| R8,0x16 | 11000 | 2700 | 3300 | 670 |
| R10,0x20 | 7000 | 2200 | 2100 | 550 |

RPM = kierros/min.
Syöttö = mm/min.

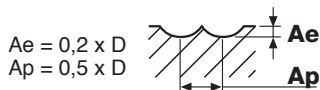

Malli EI 996

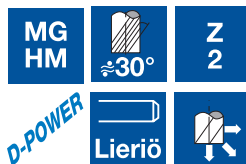
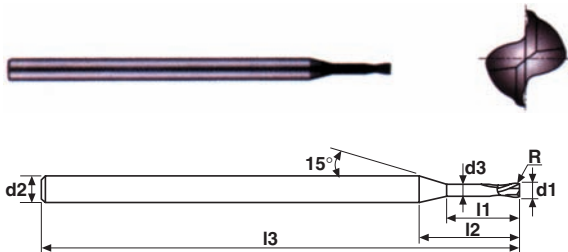

**TIMANTTI-PINNOITE
GRAFIITTIA VARTEN.**

| Toleranssit (mm) | |
|------------------------|-------------|
| Halkaisijan toleranssi | 0 -0,015 |
| Varren toleranssi | 0 -0,006 |

| Tuotenumero | d1 mm | R ± 0,01 | l1 mm | l2 mm | l3 mm | d3 mm | d2 mm | Hinta |
|-------------|----------|-------------|----------|----------|----------|----------|----------|-------|
| 3865400 | 0,6 | R0,05 | 0,9 | 3,0 | 40 | 0,55 | 3 | 55,65 |
| 3865401 | 0,8 | R0,05 | 1,2 | 4,0 | 40 | 0,75 | 3 | 53,15 |
| 3865402 | 1,0 | R0,10 | 1,5 | 5,0 | 40 | 0,95 | 3 | 49,65 |
| 3865403 | 1,0 | R0,10 | 1,5 | 8,5 | 40 | 0,95 | 3 | 49,65 |
| 3865404 | 1,2 | R0,10 | 1,8 | 6,0 | 50 | 1,15 | 3 | 49,90 |
| 3865405 | 1,5 | R0,15 | 2,2 | 7,5 | 50 | 1,40 | 3 | 49,90 |
| 3865406 | 1,5 | R0,15 | 2,2 | 12,0 | 50 | 1,40 | 3 | 51,60 |
| 3865407 | 2,0 | R0,15 | 2,2 | 10,0 | 60 | 1,90 | 3 | 48,60 |
| 3865408 | 2,0 | R0,15 | 2,2 | 16,0 | 60 | 1,90 | 3 | 50,70 |

Työstöarvosuositus

| Materiaali | Grafiitti | |
|------------|-----------|------------|
| | Ø mm | RPM Syöttö |
| 0,6 | 40000 | 640 |
| 0,8 | 40000 | 800 |
| 1 | 40000 | 960 |
| 1,2 | 40000 | 1200 |
| 1,5 | 40000 | 1440 |
| 2 | 40000 | 1600 |

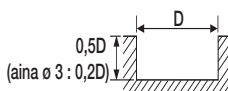

Malli EI A13



| Halk. toleranssi Ø mm | Varren toleranssi |
|--------------------------|----------------------|
| 2 – 6 | -0,010 -0,050 |
| 6 – 12 | 0 -0,006 |
| | h6 |

**TIMANTTI-PINNOITE
GRAFIITTIA VARTEN.**

| Tuotenro | d1 mm | R ± 0,01 | L mm | l mm | d2 h6 | Hinta |
|----------|----------|-------------|---------|---------|----------|---------------|
| 3865420 | 2,0 | R0,15 | 40 | 6 | 3 | 41,90 |
| 3865421 | 3,0 | R0,15 | 40 | 12 | 3 | 43,60 |
| 3865422 | 4,0 | R0,20 | 50 | 14 | 4 | 59,90 |
| 3865423 | 5,0 | R0,30 | 50 | 16 | 5 | 63,40 |
| 3865424 | 6,0 | R0,30 | 65 | 20 | 6 | 83,50 |
| 3865425 | 8,0 | R0,50 | 65 | 20 | 8 | 124,50 |
| 3865426 | 10,0 | R0,50 | 75 | 25 | 10 | 152,00 |
| 3865427 | 12,0 | R0,50 | 75 | 25 | 12 | 186,00 |

Työstöarvosuositus

| Materiaali | Grafiitti | |
|------------|-----------|------------|
| | Ø mm | RPM Syöttö |
| 2 | 40000 | 3000 |
| 3 | 40000 | 4200 |
| 4 | 40000 | 6000 |
| 5 | 40000 | 7200 |
| 6 | 40000 | 8400 |
| 8 | 32000 | 8400 |
| 10 | 26000 | 8600 |
| 12 | 21000 | 8200 |

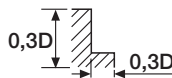

RPM = kierrosta/min.
Syöttö = mm/min.

Malli EI 997

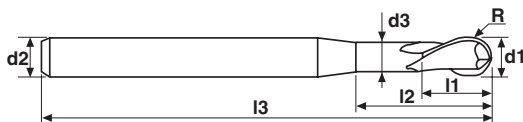

| Toleranssit (mm) | |
|------------------------|------------------|
| Halkaisijan toleranssi | -0,014 -0,028 |
| Varren toleranssi | 0 -0,006 |

**TIMANTTI-PINNOITE
GRAFIITTIA VARTEN.**

| Tuotenro | d1 mm | R ± 0,01 | l3 mm | l1 mm | l2 mm | d3 mm | d2 mm | Hinta |
|----------|----------|-------------|----------|----------|----------|----------|----------|-------|
| 3865460 | 0,6 | R0,30 | 40 | 0,6 | 3,0 | 0,55 | 3 | 71,40 |
| 3865461 | 0,8 | R0,40 | 40 | 0,8 | 4,0 | 0,75 | 3 | 59,40 |
| 3865462 | 1,0 | R0,50 | 40 | 1,0 | 5,0 | 0,95 | 3 | 56,40 |
| 3865463 | 1,0 | R0,50 | 40 | 1,0 | 8,5 | 0,95 | 3 | 56,40 |
| 3865464 | 1,2 | R0,60 | 50 | 1,2 | 6,0 | 1,15 | 3 | 56,50 |
| 3865465 | 1,5 | R0,75 | 50 | 1,5 | 7,5 | 1,40 | 3 | 56,50 |
| 3865466 | 1,5 | R0,75 | 50 | 1,5 | 12,0 | 1,40 | 3 | 58,80 |
| 3865467 | 2,0 | R1,00 | 60 | 2,2 | 10,0 | 1,90 | 3 | 54,40 |
| 3865468 | 2,0 | R1,00 | 60 | 2,2 | 16,0 | 1,90 | 3 | 56,40 |

Työstöarvosuositus

| Materiaali | Grafiitti | |
|------------|-----------|--------|
| Ø mm | RPM | Syöttö |
| 0,6 | 40000 | 800 |
| 0,8 | 40000 | 960 |
| 1 | 40000 | 1200 |
| 1,2 | 40000 | 1440 |
| 1,5 | 40000 | 1600 |
| 2 | 40000 | 2000 |

