







## (HM) Kovametallijyrsimet

## 211-223

E 5424		2-leikk. lyhyt	212
E 5445		2-leikk. pitkä	213
E 5425		3-leikk. lyhyt	214
E 5433		3-leikk. pitkä	215
E 5432		4-leikk. lyhyt	216
E 5449		4-leikk. pitkä	217
E 5624		2-leikk. pallopäinen	218



## Malli E 5424 EQ 424 TiAlN pinnoite

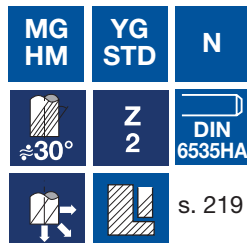
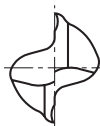

Toleranssiarvot,  $\mu = 1/1000$  mm

$\emptyset$ mm	1,0-3,0	<3,0-6,0	<6,0-10	<10-18	<18-30
h10	0 -40	0 -40	0 -58	0 -70	0 -84
h6	0 -6	0 -8	0 -9	0 -11	0 -13

**TiAlN -pinnoite**

d1 h10	Malli E 5424...	L mm	l mm	d2 h6	E5424		EQ424	
					Tuotenro	Hinta	Tuotenro	Hinta
1	...010	40	3	4	3861500	<b>13,59</b>	3861530	<b>18,40</b>
1,5	...015	40	4,5	4	3861501	<b>12,95</b>	-	-
2	...020	32	8	2	3861502	<b>10,79</b>	3861532	<b>15,65</b>
2,5	...025	32	8	2,5	3861503	<b>10,79</b>	-	-
3	...030	32	12	3	3861504	<b>10,79</b>	3861534	<b>15,65</b>
3,5	...035	32	12	3,5	3861505	<b>12,34</b>	-	-
4	...040	40	12	4	3861506	<b>12,34</b>	3861536	<b>17,10</b>
4,5	...045	50	14	4,5	3861507	<b>13,09</b>	-	-
5	...050	50	14	5	3861508	<b>13,09</b>	3861538	<b>17,92</b>
5,5	...055	50	16	5,5	3861509	<b>14,71</b>	-	-
6	...060	50	16	6	3861510	<b>14,71</b>	3861540	<b>19,53</b>
7	...070	60	20	7	3861511	<b>18,78</b>	3861541	<b>27,20</b>
8	...080	60	20	8	3861512	<b>23,60</b>	3861542	<b>31,95</b>
9	...090	60	20	9	3861513	<b>33,15</b>	3861543	<b>41,95</b>
10	...100	70	22	10	3861514	<b>35,55</b>	3861544	<b>44,60</b>
12	...120	70	22	12	3861515	<b>49,70</b>	3861546	<b>59,20</b>
14	...140	75	25	14	3861516	<b>67,80</b>	3861548	<b>78,00</b>
16	...160	75	25	16	3861517	<b>86,30</b>	3861550	<b>97,00</b>
20	...200	100	32	20	3861518	<b>144,00</b>	3861552	<b>167,00</b>

## Malli E 5445

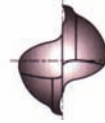

<b>MG HM</b>	<b>DIN 6527</b>	<b>N</b>
$\approx 30^\circ$	<b>Z 2</b>	<b>DIN 6535HB</b>
		s. 219

### Toleranssiarvot, $\mu = 1/1000$ mm

$\emptyset$ mm	1,0-3,0	<3,0-6,0	<6,0-10	<10-18	<18-30
e8	-14 -28	-20 -38	-25 -47	-32 -59	-40 -73
h6	0 -6	0 -8	0 -9	0 -11	0 -13

Tuotenumero	Malli E 5445...	d1 e8	L mm	l mm	d2 h6	Hinta
3864100	...901	2	38	6	*) 3	<b>11,00</b>
3864102	...030	3	57	7	6	<b>20,25</b>
3864104	...040	4	57	8	6	<b>20,25</b>
3864106	...050	5	57	10	6	<b>20,25</b>
3864108	...060	6	63	10	6	<b>20,25</b>
3864109	...070	7	63	13	8	<b>23,85</b>
3864110	...080	8	72	16	8	<b>23,85</b>
3864111	...090	9	72	16	10	<b>38,35</b>
3864113	...100	10	72	19	10	<b>38,35</b>
3864115	...120	12	83	22	12	<b>55,00</b>
3864116	...140	14	83	22	14	<b>70,80</b>
3864118	...160	16	92	26	16	<b>95,00</b>
3864120	...180	18	92	26	18	<b>124,50</b>
3864122	...200	20	104	32	20	<b>154,50</b>

\*) Lieriövarsi



## Malli E 5425 EQ 425 TiAlN pinnoite

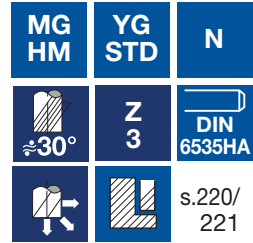

Toleranssiarvot,  $\mu = 1/1000$  mm

Ø mm	1,0-3,0	<3,0-6,0	<6,0-10	<10-18	<18-30
h10	0 -40	0 -40	0 -58	0 -70	0 -84
h6	0 -6	0 -8	0 -9	0 -11	0 -13

**TiAlN -pinnoite**

d1 h10	Malli E 5425...	L mm	l mm	d2 h6	E5425		EQ425	
					Tuotenro	Hinta	Tuotenro	Hinta
2	...020	32	8	2	3861560	<b>10,79</b>	3861590	<b>15,65</b>
2,5	...025	32	8	2,5	3861561	<b>10,79</b>	-	-
3	...030	32	12	3	3861562	<b>10,79</b>	3861592	<b>15,65</b>
3,5	...035	32	12	3,5	3861563	<b>12,34</b>	-	-
4	...040	40	12	4	3861564	<b>12,34</b>	3861594	<b>17,10</b>
4,5	...045	50	14	4,5	3861565	<b>13,09</b>	-	-
5	...050	50	14	5	3861566	<b>13,09</b>	3861596	<b>17,92</b>
5,5	...055	50	16	5,5	3861567	<b>14,71</b>	-	-
6	...060	50	16	6	3861568	<b>14,71</b>	3861598	<b>19,53</b>
7	...070	60	20	7	3861569	<b>18,78</b>	-	-
8	...080	60	20	8	3861570	<b>23,60</b>	3861600	<b>31,95</b>
9	...090	60	20	9	3861571	<b>33,15</b>	-	-
10	...100	70	22	10	3861572	<b>35,55</b>	3861602	<b>44,60</b>
12	...120	70	22	12	3861574	<b>49,70</b>	3861604	<b>59,20</b>
14	...140	75	25	14	3861576	<b>67,80</b>	3861606	<b>78,00</b>
16	...160	75	25	16	3861578	<b>86,30</b>	3861608	<b>97,00</b>
20	...200	100	32	20	3861580	<b>144,00</b>	3861610	<b>167,00</b>

## Malli E 5433

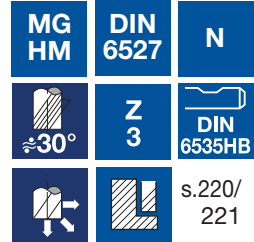

### Toleranssiarvot, $\mu = 1/1000$ mm

$\varnothing$ mm	1,0-3,0	<3,0-6,0	<6,0-10	<10-18	<18-30
e8	0 -40	0 -48	0 -58	0 -70	0 -84
h6	0 -6	0 -8	0 -9	0 -11	0 -13

Tuotenro	Malli E 5433...	d1 e8	L mm	l mm	d2 h6	Hinta
3864150	...030	3	57	7	6	<b>20,30</b>
3864152	...040	4	57	8	6	<b>20,30</b>
3864153	...050	5	57	10	6	<b>20,30</b>
3864155	...060	6	57	10	6	<b>20,30</b>
3864156	...080	8	63	16	8	<b>23,85</b>
3864157	...100	10	72	19	10	<b>38,45</b>
3864158	...120	12	83	22	12	<b>55,10</b>
3864160	...140	14	83	22	14	<b>70,90</b>
3864159	...160	16	92	26	16	<b>95,10</b>
3864161	...180	18	92	26	18	<b>125,00</b>
3864162	...200	20	104	32	20	<b>155,00</b>



## Malli E 5432 EQ 432 TiAIN pinnoite



MG HM	YG STD	N
30°	Z 4	DIN 6535HA
		s. 222

Toleranssiarvot,  $\mu = 1/1000$  mm

Ø mm	1,0-3,0	<3,0-6,0	<6,0-10	<10-18	<18-30
h10	0 -40	0 -40	0 -58	0 -70	0 -84
h6	0 -6	0 -8	0 -9	0 -11	0 -13

**TiAIN -pinnoite**

d1 h10	Malli E 5432...	L mm	l mm	d2 h6	E5432		EQ432	
					Tuotenumro	Hinta	Tuotenumro	Hinta
2	...020	32	8	2	3861680	<b>10,79</b>	3861710	<b>15,65</b>
2,5	...025	32	8	2,5	3861681	<b>10,79</b>	-	-
3	...030	32	12	3	3861682	<b>10,79</b>	3861712	<b>15,65</b>
3,5	...035	32	12	3,5	3861683	<b>12,34</b>	-	-
4	...040	40	12	4	3861684	<b>12,34</b>	3861714	<b>17,10</b>
4,5	...045	50	14	4,5	3861685	<b>13,09</b>	-	-
5	...050	50	14	5	3861686	<b>13,09</b>	3861716	<b>17,92</b>
5,5	...055	50	16	5,5	3861687	<b>14,71</b>	-	-
6	...060	50	16	6	3861688	<b>14,71</b>	3861718	<b>19,53</b>
7	...070	60	20	7	3861689	<b>18,78</b>	3861719	<b>27,20</b>
8	...080	60	20	8	3861690	<b>23,60</b>	3861720	<b>31,95</b>
9	...090	60	20	9	3861691	<b>33,15</b>	3861721	<b>41,95</b>
10	...100	70	22	10	3861692	<b>35,55</b>	3861722	<b>44,60</b>
12	...120	70	22	12	3861694	<b>49,70</b>	3861724	<b>59,20</b>
14	...140	75	25	14	3861696	<b>67,80</b>	3861726	<b>78,00</b>
16	...160	75	25	16	3861698	<b>86,30</b>	3861728	<b>97,00</b>
20	...200	100	32	20	3861700	<b>144,00</b>	3861730	<b>167,00</b>

## Malli E 5449

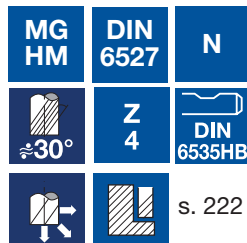

### Toleranssiarvot, $\mu = 1/1000$ mm

$\emptyset$ mm	1,0-3,0	<3,0-6,0	<6,0-10	<10-18	<18-30
e8	0 -40	0 -48	0 -58	0 -70	0 -84
h6	0 -6	0 -8	0 -9	0 -11	0 -13

Tuotenumero	Malli E 5449...	d1 e8	L mm	l mm	d2 h6	Hinta
3864200	...901	2	38	6	*) 3	<b>11,00</b>
3864201	...030	3	57	7	6	<b>20,85</b>
3864203	...040	4	57	8	6	<b>21,70</b>
3864205	...050	5	57	10	6	<b>21,70</b>
3864206	...060	6	63	10	6	<b>21,70</b>
3864207	...070	7	63	13	8	<b>25,05</b>
3864208	...080	8	72	16	8	<b>25,05</b>
3864209	...100	10	72	19	10	<b>40,05</b>
3864210	...120	12	83	22	12	<b>56,70</b>
3864212	...140	14	83	22	14	<b>75,10</b>
3864215	...160	16	92	26	16	<b>103,50</b>
3864217	...180	18	92	26	18	<b>133,50</b>
3864219	...200	20	104	32	20	<b>163,50</b>

\*) Lieriövarsi



# Täyskovametallijyrin Pallopäinen

## Malli E 5624 EQ 624 TiAlN pinnoite

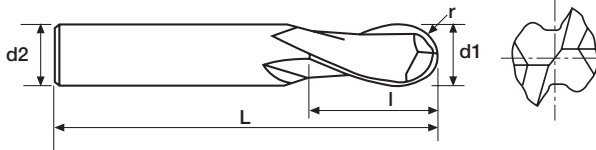

MG HM	YG STD	N
30°	Z 2	DIN 6535HA
		s. 223

### Toleranssiarvot, $\mu = 1/1000$ mm

Ø mm	1,0-3,0	<3,0-6,0	<6,0-10	<10-18	<18-30
e8	-14 -28	-20 -38	-25 -47	-32 -59	-40 -73
h6	0 -6	0 -8	0 -9	0 -11	0 -13

**TiAlN -pinnoite**

d1 e8	Malli E 5624...	r mm	L mm	l mm	d2 h6	E5624		EQ624	
						Tuotenro	Hinta	Tuotenro	Hinta
2	...020	1	48	4	6	3861800	<b>15,26</b>	3861840	<b>20,05</b>
2,5	...025	1,25	48	4	6	3861801	<b>15,26</b>	3861841	<b>20,05</b>
3	...030	1,5	48	4	6	3861802	<b>15,26</b>	3861842	<b>20,05</b>
4	...040	2	50	6	6	3861805	<b>16,07</b>	3861846	<b>20,85</b>
4	...901	2	40	12	4	3861806	<b>15,37</b>	-	-
5	...050	2,5	51	7	6	3861807	<b>16,79</b>	3861848	<b>21,60</b>
5	...902	2,5	50	14	5	3861808	<b>16,38</b>	-	-
6	...060	3	51	7	6	3861810	<b>18,40</b>	3861850	<b>23,25</b>
8	...080	4	59	9	8	3861814	<b>28,25</b>	3861854	<b>36,55</b>
10	...100	5	60	10	10	3861816	<b>45,05</b>	3861856	<b>53,90</b>
12	...120	6	71	14	12	3861818	<b>58,60</b>	3861858	<b>68,30</b>
14	...140	7	71	14	14	3861820	<b>69,60</b>	3861860	<b>79,80</b>
16	...160	8	76	16	16	3861822	<b>94,00</b>	3861862	<b>106,00</b>
18	...180	9	76	18	18	3861825	<b>101,50</b>	3861865	<b>116,00</b>
20	...200	10	82	20	20	3861828	<b>144,00</b>	3861868	<b>164,00</b>

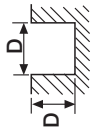

## Malli E5424, E5445 2-leikkuinen, viimeistely, urajyrsintä

Materiaali	Hiliteräs Seosteräs Työkaluteräs	Hiliteräs Seosteräs Työkaluteräs	Hiliteräs Seosteräs Työkaluteräs	Ruostumaton teräs Seostitaani	Valurauta	Alumiini, seostettu
Kovuus Vetoluj. Ø	~HRc20 500~800N/mm <sup>2</sup> RPM: Syöttö	HRc20~HRc30 800~1000N/mm <sup>2</sup> RPM: Syöttö	HRc30~HRc40 1000~1300N/mm <sup>2</sup> RPM: Syöttö	RPM: Syöttö	RPM: Syöttö	RPM: Syöttö
2	5500 80	4800 70	4000 55	8000 65	6500 150	16000 320
3	3700 90	3200 80	2600 60	5300 65	4200 150	11000 320
4	2800 90	2400 80	2000 60	4000 65	3200 150	8000 320
5	2200 90	1900 80	1600 60	3200 65	2500 150	6400 320
6	1800 90	1600 80	1300 60	2600 65	2100 180	5300 340
8	1400 90	1200 80	1000 60	2000 65	1600 190	4000 340
10	1100 90	950 80	800 60	1600 65	1300 200	3200 340
12	900 90	800 80	660 60	1300 65	1000 210	2600 340
14	800 90	700 80	570 60	1100 65	900 220	2300 340
16	700 100	600 85	500 75	1000 75	800 225	2000 340
20	550 100	480 85	400 75	800 80	640 240	1600 340

RPM = kierrokset/min  
Syöttö = mm/min

## Malli EQ 424 TiAIN-pinnoite

2	7200 100	6200 90	5200 70	7000 85	8500 200	20000 420
3	4800 120	4200 105	3400 80	6900 85	5500 200	14000 420
4	3640 120	3100 105	2600 80	5200 85	4200 200	10000 420
5	2860 120	2500 105	2000 80	4200 85	3300 200	8300 420
6	2400 120	2000 105	1700 80	3400 85	2700 230	6900 440
8	1800 120	1500 105	1300 80	2600 85	2000 250	5200 440
10	1400 120	1200 105	1000 80	2000 85	1700 260	4200 440
12	1200 120	1000 105	860 80	1700 85	1300 270	3400 440
14	1000 120	900 105	740 80	1400 85	1200 280	3000 440
16	900 130	800 110	650 100	1300 100	1000 290	2600 440
20	720 130	620 110	520 100	1000 100	830 310	2000 440

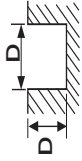

## Malli E5425, E5433 3-leikkuinen, viimeistely, urajyrsintä

Materiaali	Hiljiteräs Seosteräs Työkaluteräs	Hiljiteräs Seosteräs Työkaluteräs	Hiljiteräs Seosteräs Työkaluteräs	Ruostumaton teräs Seostitaani	Valurauta	Alumiini, seostettu
Kovuus Vetoluj. Ø	~ HRC20 500~800N/mm <sup>2</sup> RPM Syöttö	HRC20~HRC30 800~1000N/mm <sup>2</sup> RPM Syöttö	HRC30~HRC40 1000~1300N/mm <sup>2</sup> RPM Syöttö	RPM Syöttö	RPM Syöttö	RPM Syöttö
2	5500 70	4800 60	4000 50	8000 55	6500 140	16000 290
3	3700 80	3200 75	2600 55	5300 55	4200 140	11000 300
4	2800 80	2400 75	2000 55	4000 55	3200 130	8000 290
5	2200 80	1900 70	1600 55	3200 55	2500 135	6400 290
6	1800 80	1600 70	1300 55	2600 60	2100 160	5300 305
8	1400 80	1200 70	1000 55	2000 60	1600 170	4000 310
10	1100 80	950 70	800 55	1600 60	1300 180	3200 305
12	900 80	800 70	660 55	1300 60	1000 190	2600 300
14	800 80	700 70	570 55	1100 60	900 200	2300 300
16	700 90	600 75	500 65	1000 75	800 200	2000 300
20	550 90	480 75	400 65	800 70	640 215	1600 300

RPM = kierrokset/min  
Syöttö = mm/min

## TiAIN-pinnoite

## Malli EQ 425

2	7200 90	6200 80	5200 65	10000 70	8500 180	20000 380
3	4800 105	4200 100	3400 70	6900 70	5500 180	14000 390
4	3640 105	3100 100	2600 70	5200 70	4200 170	10000 380
5	2860 105	2500 90	2000 70	4200 70	3300 180	8300 380
6	2400 105	2000 90	1700 70	3400 80	2700 210	6900 400
8	1800 105	1500 90	1300 70	2600 80	2000 220	5200 400
10	1400 105	1200 90	1000 70	2000 80	1700 230	4200 400
12	1200 105	1000 90	860 70	1700 80	1300 250	3400 390
14	1000 105	900 90	740 70	1400 80	1200 260	3000 390
16	900 120	800 100	650 85	1300 90	1000 260	2600 390
20	720 120	620 100	520 85	1000 90	830 280	2000 390

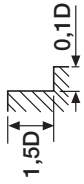

## Malli E5425, E5433 3-leikkuinen, viimeistely, sivujuysrintä

Materiaali	Hiiliiteräs Seosteräs Työkaluteräs		Hiiliiteräs Seosteräs Työkaluteräs		Ruostumaton teräs Seostitaani		Valurauta		Alumiini, seostettu	
	~HRC20 500~800N/mm <sup>2</sup> RPM, Syöttö	HRC20~HRC30 800~1000N/mm <sup>2</sup> RPM, Syöttö	HRC30~HRC40 1000~1300N/mm <sup>2</sup> RPM, Syöttö	4000 120 2600 130 2000 130 1600 130	8000 140 5300 140 4000 140 3200 140	2600 150 2000 150 1600 150 1300 150	6500 330 4200 330 3200 340 2500 340	2100 400 1600 430 1300 450 1000 470	16000 720 11000 690 8000 720 6400 710	RPM, Syöttö
<b>2</b>	5500 180	4800 160	4000 120	8000 140	2600 150	6500 330	2100 400	16000 720		
<b>3</b>	3700 200	3200 170	2600 130	5300 140	2000 150	4200 330	1600 430	11000 690		
<b>4</b>	2800 200	2400 180	2000 130	4000 140	1600 150	3200 340	1300 450	8000 720		
<b>5</b>	2200 200	1900 180	1600 130	3200 140	1300 150	2500 340	1000 470	6400 710		
<b>6</b>	1800 200	1600 180	1300 130	2600 150	1100 150	2100 400	900 490	5300 760		
<b>8</b>	1400 200	1200 180	1000 130	2000 150	1000 170	1600 430	800 510	4000 760		
<b>10</b>	1100 200	950 180	800 130	1600 150	800 180	1300 450	640 540	2600 760		
<b>12</b>	900 200	800 180	660 130	1300 150	800 180	1000 470				
<b>14</b>	800 200	700 180	570 130	1100 150	800 180					
<b>16</b>	700 220	600 190	500 160	1000 170	800 180					
<b>20</b>	550 220	480 190	400 160	800 180						

RPM = kierrokset/min  
Syöttö = mm/min

## TiAIN-pinnoite

<b>2</b>	7200 230	6200 210	5200 160	10000 180	8500 430	20000 940
<b>3</b>	4800 260	4200 220	3400 170	6900 180	5500 430	14000 900
<b>4</b>	3640 260	3100 230	2600 170	5200 180	4200 440	10000 940
<b>5</b>	2860 260	2500 230	2000 170	4200 180	3300 440	8300 920
<b>6</b>	2400 260	2000 230	1700 170	3400 200	2700 520	6900 1000
<b>8</b>	1800 260	1500 230	1300 170	2600 200	2000 560	5200 1000
<b>10</b>	1400 260	1200 230	1000 170	2000 200	1700 580	4200 1000
<b>12</b>	1200 260	1000 230	860 170	1700 200	1300 610	3400 1000
<b>14</b>	1000 260	900 230	740 170	1400 200	1200 640	3000 1000
<b>16</b>	900 280	800 250	650 210	1300 220	1000 660	2600 1000
<b>20</b>	720 280	620 250	520 210	1000 230	830 700	2000 1000

## Malli EQ 425

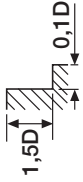

## Malli E5432, E5449 4-leikkuinen, viimeistely, sivujuysrintä

Materiaali	Hiiliteräs Seosteräs Työkaluteräs		Hiiliteräs Seosteräs Työkaluteräs		Ruostumaton teräs Seostitaani		Valurauta		Alumiini, seostettu	
	~HRC20 500~800N/mm <sup>2</sup> RPM, Syöttö	HRC20~HRC30 800~1000N/mm <sup>2</sup> RPM, Syöttö	HRC30~HRC40 1000~1300N/mm <sup>2</sup> RPM, Syöttö	4000 160 2600 180 2000 180 1600 180	8000 200 5300 200 4000 200 3200 200	2600 200 2000 200 1600 200 1300 200	6500 450 4200 450 3200 450 2500 450	2100 540 1600 570 1300 600 1000 630	16000 960 11000 960 8000 960 6400 960	
<b>2</b>	5500 240	4800 210	4000 160	8000 200	2600 200	6500 450	2100 540	16000 960		
<b>3</b>	3700 270	3200 240	2600 180	5300 200	2000 200	4200 450	1600 570	11000 960		
<b>4</b>	2800 270	2400 240	2000 180	4000 200	1600 200	3200 450	1300 600	8000 960		
<b>5</b>	2200 270	1900 240	1600 180	3200 200	1300 200	2500 450	1000 630	6400 960		
<b>6</b>	1800 270	1600 240	1300 180	2600 200	1100 200	2100 540	900 660	5300 1020		
<b>8</b>	1400 270	1200 240	1000 180	2000 200	1000 200	1600 570	800 680	4000 1020		
<b>10</b>	1100 270	950 240	800 180	1600 200	1000 225	1300 600	800 680	3200 1020		
<b>12</b>	900 270	800 240	660 180	1300 200	800 240	1000 630	640 720	2600 1020		
<b>14</b>	800 270	700 240	570 180	1100 200	800 240	900 660	2300 1020	2300 1020		
<b>16</b>	700 300	600 260	500 220	1000 225	800 240	800 680	2000 1020	2000 1020		
<b>20</b>	550 300	480 260	400 220	800 240	800 240	640 720	1600 1020	1600 1020		

RPM = kierrokset/min  
Syöttö = mm/min

## Malli EQ 432

	TiAlN-pinnoite	
	RPM	Syöttö
<b>2</b>	7200 310	10000 260
<b>3</b>	4800 350	6900 260
<b>4</b>	3640 350	5200 260
<b>5</b>	2860 350	4200 260
<b>6</b>	2400 350	3400 260
<b>8</b>	1800 350	2600 260
<b>10</b>	1400 350	2000 260
<b>12</b>	1200 350	1700 260
<b>14</b>	1000 350	1400 260
<b>16</b>	900 390	1300 290
<b>20</b>	720 390	1000 310

## Malli E 5624

## 2-leikkuinen, pallopäinen

Materiaali	Hiiliteräs Seosteräs Työkaluteräs	Hiiliteräs Seosteräs Työkaluteräs	Valurauta	Alumiini, seostettu
Kovuus Vetolujuus Ø	~HRc30 ~1000 N/mm <sup>2</sup> RPM Syöttö	HRc30-HRc40 1000~1300N/mm <sup>2</sup> RPM Syöttö	RPM Syöttö	RPM Syöttö
<b>R 1,0 x 2,0</b>	5200 90	4400 45	7300 150	21500 280
<b>R 1,5 x 3,0</b>	3500 100	2900 45	4900 160	14300 280
<b>R 2,0 x 4,0</b>	2600 100	2100 45	3600 200	10900 280
<b>R 2,5 x 5,0</b>	2100 105	1700 45	2900 230	8800 330
<b>R 3,0 x 6,0</b>	1700 100	1430 45	2400 250	7260 330
<b>R 4,0 x 8,0</b>	1270 95	1100 45	1800 320	5500 380
<b>R 5,0 x 10,0</b>	1000 95	870 45	1430 320	4300 380
<b>R 6,0 x 12,0</b>	870 85	730 45	1200 320	3600 440
<b>R 7,0 x 14,0</b>	750 85	620 45	1000 325	3000 440
<b>R 8,0 x 16,0</b>	650 85	540 45	920 325	2700 380
<b>R 9,0 x 18,0</b>	580 85	480 45	810 325	2400 380
<b>R10,0 x 20,0</b>	500 85	430 45	730 290	2100 380

RPM = kierrokset/min  
Syöttö = mm/min

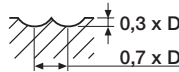

## Malli EQ 624

## 2-leikkuinen, pallopäinen, TiAlN-pinnoite

Materiaali	Hiiliteräs Seosteräs Työkaluteräs	Hiiliteräs Seosteräs Työkaluteräs	Valurauta	Alumiini, seostettu
Kovuus Vetolujuus Ø	~HRc30 ~1000 N/mm <sup>2</sup> RPM Syöttö	HRc30-HRc40 1000~1300N/mm <sup>2</sup> RPM Syöttö	RPM Syöttö	RPM Syöttö
<b>R 1,0 x 2,0</b>	6760 120	5700 60	9500 200	28000 360
<b>R 1,5 x 3,0</b>	4500 130	3800 60	6400 210	18600 360
<b>R 2,0 x 4,0</b>	3400 130	2700 60	4700 260	14000 360
<b>R 2,5 x 5,0</b>	2700 135	2200 60	3800 300	11000 430
<b>R 3,0 x 6,0</b>	2200 130	1860 60	3100 330	9400 430
<b>R 4,0 x 8,0</b>	1600 120	1400 60	2300 420	7200 490
<b>R 5,0 x 10,0</b>	1300 120	1100 60	1860 420	5600 490
<b>R 6,0 x 12,0</b>	1100 110	950 60	1600 420	4700 570
<b>R 7,0 x 14,0</b>	980 110	800 60	1300 420	3900 570
<b>R 8,0 x 16,0</b>	850 110	700 60	1200 420	3500 490
<b>R 9,0 x 18,0</b>	750 110	620 60	1000 420	3100 490
<b>R10,0 x 20,0</b>	650 110	560 60	950 380	2700 490

RPM = kierrokset/min  
Syöttö = mm/min