



DIAL INDICATOR  
TEST INDICATOR  
LINEAR GAGE  
MAGNETIC STAND  
MEASURING TABLE  
BENCH CENTER

## ELECTRONIC DIGITAL INDICATOR



Code	Range	Stem diameter
2101-10	0-10mm/0-0.5"	8mm
2101-25	0-25mm/0-1"	8mm
2101-10E	0-0.5"/0-10mm	3/8"
2101-25E	0-1"/0-25mm	3/8"

- Resolution: 0.005mm/0.0005"
- Buttons: mm/inch, on/off, zero
- Lug back (flat back is optional)
- CR2032 battery, with spare battery, automatic power off
- USB data output
- Packed in plastic box

## ELECTRONIC DIGITAL INDICATOR



Code	Range	Stem diameter
2102-10	0-10mm/0-0.5"	8mm
2102-25	0-25mm/0-1"	8mm
2102-10E	0-0.5"/0-10mm	3/8"
2102-25E	0-1"/0-25mm	3/8"

- Resolution: 0.005mm/0.0005"
- Rotary display
- 'Mode' button:
  - to find the difference between minimum and maximum reading
  - to track the minimum or maximum reading
- '+/-' button is for measuring direction change
- Lug back (flat back is optional)
- CR2032 battery, with one spare battery, automatic power off
- USB data output
- Packed in plastic box

## LONG RANGE ELECTRONIC DIGITAL INDICATOR



Code	Range	Stem diameter
2107-50	0-50mm/0-2"	8mm
2107-50E	0-2"/0-50mm	3/8"

- Resolution: 0.005mm/0.0002"
- Buttons: mm/inch, ABS/INC, zero
- Flat back and supplied with spare lug back
- CR2032 battery, with spare battery, automatic power off
- USB data output
- Packed in plastic box

## PRECISION ELECTRONIC DIGITAL INDICATOR



- Rotary display in digit and analog
- Absolute/relative measurement, range measurement, tolerance measurement
- Lug back (flat back is optional)
- CR2032 battery, with spare battery, automatic power off
- Data output
- Packed in plastic box

Code	Range	Resolution	Stem diameter
2105-101	0-10mm/0-0.5"	0.001mm/0.00005"	8mm
2105-101E	0-0.5"/0-10mm	0.00005"/0.001mm	3/8"

## ELECTRONIC DIGITAL INDICATOR FOR BORE GAGE



- Specially designed for bore gage
- Rotary display in digit and analog
- Absolute/relative measurement
- Lug back (flat back is optional)
- CR2032 battery, with spare battery, automatic power off
- Data output
- Packed in plastic box

Code	Range	Resolution	Stem diameter
2106-102	0-10mm/0-0.5"	0.002mm/0.00005"	8mm
2106-101	0-10mm/0-0.5"	0.001mm/0.00005"	8mm
2106-102E	0-0.5"/0-10mm	0.00005"/0.002mm	3/8"
2106-101E	0-0.5"/0-10mm	0.00005"/0.001mm	3/8"

## METRIC DIAL INDICATOR



Code	Range	Graduation
2311-3F	0-3mm	0.01mm
2311-5F	0-5mm	0.01mm

- Jeweled
- Bezel diameter 42mm, stem diameter 8mm
- Flat back (lug back is optional)
- With tolerance index
- Satin chrome plated steel body
- Meet DIN878
- Packed in plastic box

## METRIC DIAL INDICATOR



Code	Range	Graduation
2308-3F	0-3mm	0.01mm
2308-5F	0-5mm	0.01mm
2308-10F	0-10mm	0.01mm

- Jeweled
- Bezel diameter 58mm, stem diameter 8mm
- Flat back (lug back is optional)
- With tolerance index
- Satin chrome plated steel case
- Meet DIN878
- Packed in plastic box

## METRIC DIAL INDICATOR



Code	Range	Graduation
2310-30F	0-30mm	0.01mm

- Jeweled
- Bezel diameter 58mm, stem diameter 8mm
- Flat back (lug back is optional)
- With tolerance index
- Satin chrome plated steel body
- Meet DIN878
- Packed in plastic box

## METRIC DIAL INDICATOR



- Jeweled
- 2309-30F is with flat back (lug back is optional)  
2309-50, 2309-80, 2309-100 are with flat back and supplied with spare lug back
- With tolerance index
- Satin chrome plated steel body
- Meet DIN878
- Packed in plastic or wooden box

Code	Range	Graduation	Bezel diameter	Stem diameter
2309-30F	0-30mm	0.01mm	58mm	8mm
2309-50	0-50mm	0.01mm	58mm	8mm
2309-80	0-80mm	0.01mm	58mm	8mm
2309-100	0-100mm	0.01mm	78mm	10mm

## METRIC SHOCK PROOF DIAL INDICATOR



Code	Range	Graduation
2314-3F	0-3mm	0.01mm
2314-5F	0-5mm	0.01mm
2314-10F	0-10mm	0.01mm

- Shock-proof, jeweled
- Bezel diameter 58mm, stem diameter 8mm
- Flat back (lug back is optional)
- With tolerance index
- Satin chrome plated steel body
- Meet DIN878
- Packed in plastic box

## METRIC PRECISION DIAL INDICATOR



Code	Range	Graduation
2313-1F	0-1mm	0.001mm
2313-2F	0-2mm	0.001mm
2313-3F	0-3mm	0.001mm
2313-5F	0-5mm	0.001mm

- Shock proof, jeweled
- Bezel diameter 58mm, stem diameter 8mm
- Flat back (lug back is optional)
- With tolerance index
- Satin chrome plated steel body
- Meet DIN878
- Packed in plastic box

## COOLANT PROOF DIAL INDICATOR



Code	Range	Graduation
2324-10	0-10mm	0.01mm

- IP54
- Jeweled
- Bezel diameter 58mm, stem diameter 8mm
- Lug back (flat back is optional)
- Stain chrome finish steel body
- Meet DIN878
- Packed in plastic box

## METRIC DIAL INDICATOR



Code	Range	Graduation
2318-10F	0-10mm	0.1mm
2318-15F	0-15mm	0.1mm
2318-20F	0-20mm	0.1mm
2318-25F	0-25mm	0.1mm
2318-30F	0-30mm	0.1mm

- Bezel diameter 60mm, stem diameter 8mm
- Flat back (lug back is optional)
- With tolerance index
- Aluminum body
- Packed in plastic box

## METRIC DIAL INDICATOR



Code	Range	Graduation
2319-1	0-1mm	0.01mm
2319-3	0-3mm	0.01mm
2319-5	0-5mm	0.01mm

- Bezel diameter 60mm, stem diameter 8mm
- With tolerance index
- Aluminum body
- Meet DIN878
- Packed in wooden box

## METRIC DOUBLE FACE DIAL INDICATOR



Code	Range	Graduation
2328-10	0-10mm	0.01mm

- Read from both sides
- Jeweled
- Bezel diameter 58mm, stem diameter 8mm
- With tolerance index
- Satin chrome plated steel body
- Meet DIN878
- Packed in wooden box

## INCH DIAL INDICATOR



Code	Range	Graduation
2304-01	0-0.1"	0.001"
2304-02	0-0.2"	0.001"
2304-025	0-0.25"	0.001"
2304-015	0-0.1"	0.0005"
2304-0205	0-0.2"	0.0005"
2304-0255	0-0.25"	0.0005"

- Bezel diameter 1.6", stem diameter 3/8"
- Lug back
- With bezel locking clamp and tolerance index
- Aluminum body
- Meet ANSI B89.1.10
- Packed in plastic box

## INCH DIAL INDICATOR



Code	Range	Graduation
2307-025	0-0.25"	0.001"
2307-05	0-0.5"	0.001"
2307-1	0-1"	0.001"
2307-2	0-2"	0.001"
2307-0255	0-0.25"	0.0005"
2307-055	0-0.5"	0.0005"
2307-105	0-1"	0.0005"
2307-205	0-2"	0.0005"

- Bezel diameter 2.3", stem diameter 3/8"
- Lug back
- With bezel locking clamp and tolerance index
- Aluminum body
- Meet ANSI B89.1.10
- Packed in plastic box or wooden box

## INCH DIAL INDICATOR



Code	Range	Graduation
2312-15	0-1.5"	0.001"
2312-2	0-2"	0.001"
2312-155	0-1.5"	0.0005"
2312-25	0-2"	0.0005"

- Bezel diameter 3", stem diameter 3/8"
- Lugback
- With bezel locking clamp and tolerance index
- Aluminum body
- Meet ANSI B89.1.10
- Packed in plastic or wooden box

## INCH DIAL INDICATOR



Code	Range	Graduation	Bezel diameter
2326-2	0-2"	0.001"	2.3"
2326-25	0-2"	0.0005"	2.3"
2326-3	0-3"	0.001"	3.1"
2326-4	0-4"	0.001"	3.1"

- Stem diameter 3/8"
- Lug back
- With bezel locking clamp and tolerance index
- Aluminum body
- Meet ANSI B89.1.10
- Packed in wooden box

## INCH PRECISION DIAL INDICATOR



Code	Range	Graduation
2315-05	0-0.05"	0.0001"

- Shock proof, jeweled
- Bezel diameter 2.3", stem diameter 3/8"
- Lug back
- With bezel locking clamp and tolerance index
- Aluminum body
- Meet ANSI B89.1.10
- Packed in plastic box

## INCH DIAL INDICATOR



Code	Range	Graduation
2317-01	0-0.1"	0.001"
2317-02	0-0.2"	0.001"

- Bezel diameter 2.3", stem diameter 3/8"
- With tolerance index
- Aluminum body
- Meet ANSI B89.1.10
- Packed in wooden box

## DUAL GRADUATION DIAL INDICATOR



- Stem diameter 3/8" (8mm is optional)
- Lug back
- With bezel locking clamp and tolerance index
- Aluminum body
- Meet ANSI B89.1.10
- Packed in plastic box or wooden box

Code	Range	Graduation	Bezel diameter
2325-05	0-0.5"/0-12.5mm	0.001"/0.01mm	2.3"
2325-1	0-1"/0-25mm	0.001"/0.01mm	2.3"
2325-2	0-2"/0-50mm	0.001"/0.01mm	3"

## DIAL COMPARATOR



Code	Range	Graduation
2306-1F	+/-0.4mm	0.01mm

- Bezel diameter 57mm, stem diameter 8mm
- Flat back (lug back is optional)
- Packed in plastic box

## PRECISION DIAL COMPARATOR



- Stem diameter 28mm
- Packed in wooden box

Code	Range	Graduation
2305-1	+/-0.3mm	0.01mm
2305-2	+/-0.15mm	0.005mm
2305-3	+/-0.06mm	0.002mm
2305-4	+/-0.03mm	0.001mm
2305-5	+/-0.1mm	0.001mm
2305-6	+/-0.015mm	0.0005mm
2305-7	+/-0.006mm	0.0002mm

## PRECISION DIAL COMPARATOR



- Stem diameter 8mm
- Packed in wooden box

Code	Range	Graduation
2303-1	+/-0.05mm	0.001mm

## GAGE CALIBRATION INSTRUMENT

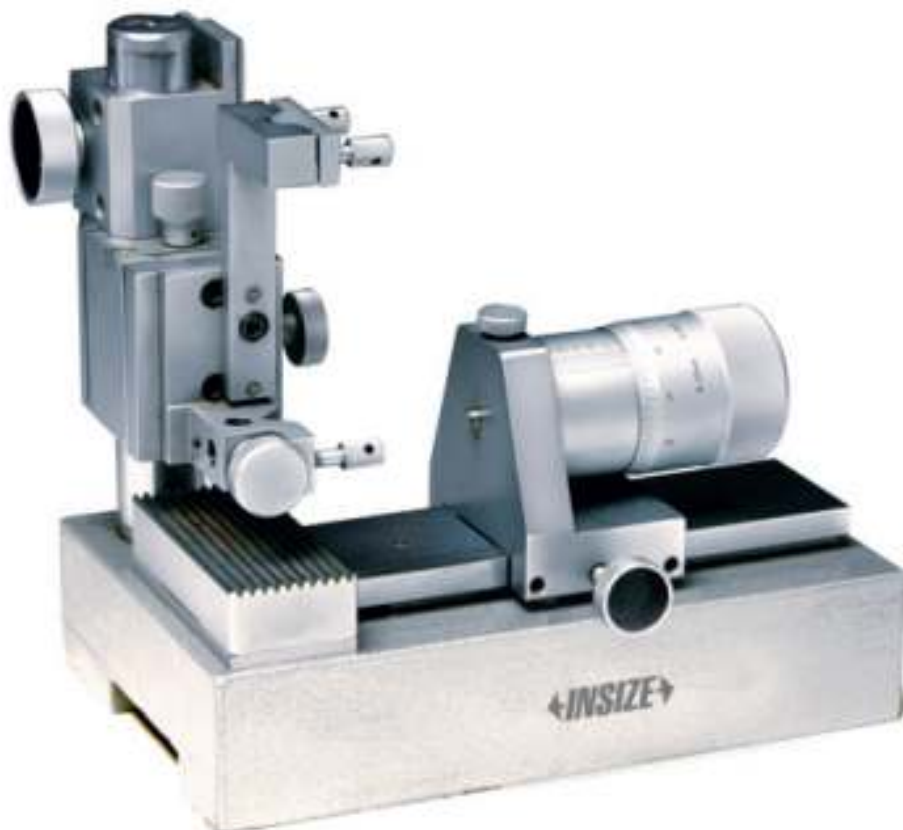

Code	Range
2396-25	0-25mm

- To calibrate dial indicator, test indicator and dial bore gage
- Micrometer head graduation 0.005mm
- With dynamometer
- Packed in wooden box

## CONTACT POINT FOR DIAL INDICATOR



## SHELL TYPE POINTS

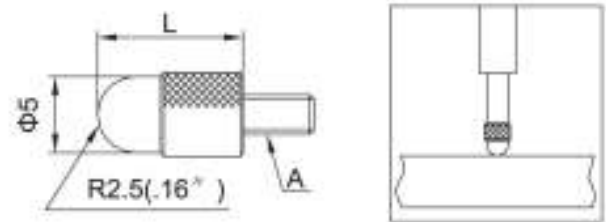

Note: R2.5 is for M2.5X0.45  
R.16" is for #4-48UNF

Code	Material	L(mm)	A
6282-0201	Steel	3.97	#4-48UNF
6282-0202	Steel	5	M2.5X0.45
6282-0203	Steel	10	M2.5X0.45
6282-0204	Steel	12.7	#4-48UNF
6282-0205	Steel	15	M2.5X0.45
6282-0206	Steel	19.05	#4-48UNF
6282-0207	Steel	20	M2.5X0.45
6282-0208	Steel	25	M2.5X0.45
6282-0209	Steel	25.4	#4-48UNF
6282-0210	Steel	30	M2.5X0.45

## BALL POINTS

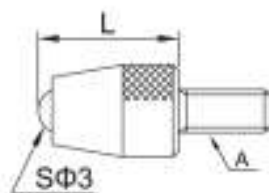

Code	Material	L(mm)	A
6282-0101	Carbide	7.3	M2.5X0.45
6282-0102	Carbide	7.3	#4-48UNF
6282-0103	Ceramic	7.3	M2.5X0.45
6282-0104	Carbide	8.3	M2.5X0.45
6282-0106	Carbide	12.1	M2.5X0.45
6282-0107	Carbide	14	M2.5X0.45
6282-0108	Carbide	15	M2.5X0.45
6282-0109	Ceramic	15	M2.5X0.45
6282-0110	Carbide	17	M2.5X0.45
6282-0111	Carbide	19.3	M2.5X0.45
6282-0112	Carbide	20	M2.5X0.45
6282-0113	Ceramic	20	M2.5X0.45
6282-0114	Carbide	22	M2.5X0.45
6282-0115	Carbide	25	M2.5X0.45
6282-0116	Ceramic	25	M2.5X0.45
6282-0117	Carbide	30	M2.5X0.45
6282-0118	Ceramic	30	M2.5X0.45

## SPHERICAL POINTS

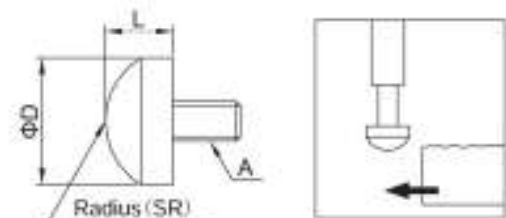

Code	Material	D(mm)	L(mm)	SR(mm)	A
6282-0401	Steel	10	5	7	M2.5X0.45
6282-0402	Steel	12.7	3.18	7	#4-48UNF
6282-0403	Steel	9.53	2.38	9	#4-48UNF

## BALL POINTS

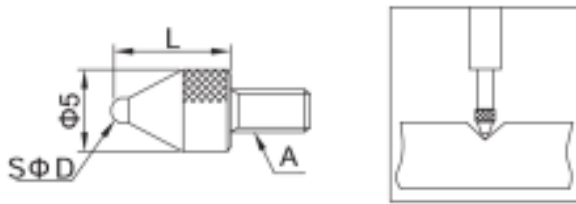

Code	Material	SΦD(mm)	A
6282-0301	Steel	1	M2.5X0.45
6282-0302	Carbide	1.5	M2.5X0.45
6282-0303	Steel	1.8	M2.5X0.45
6282-0304	Carbide	2.5	M2.5X0.45
6282-0305	Carbide	4	M2.5X0.45
6282-0306	Carbide	4	#4-48UNF

## CONICAL POINTS

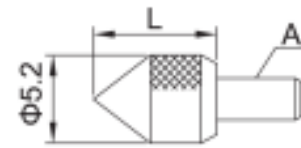

Code	Material	Tip angle	L(mm)	A
6282-0701	Steel	90°	5	M2.5X0.45
6282-0702	Steel	90°	7.14	#4-48UNF

## SPHERICAL POINTS

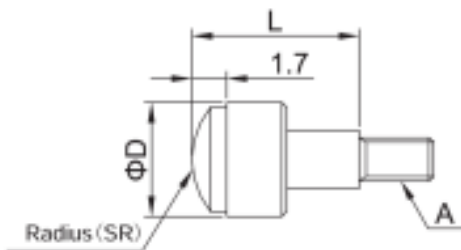

Code	Material	D(mm)	L(mm)	SR(mm)	A
6282-0501	Steel	5.2	5	5	M2.5X0.45
6282-0502	Steel	7.5	10	7	M2.5X0.45
6282-0503	Steel	10.5	10	10	M2.5X0.45

## CONICAL POINTS

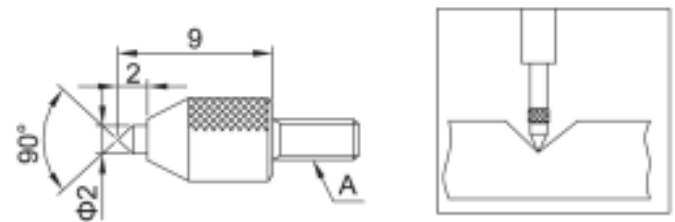

Code	Material	A
6282-0801	Steel	M2.5X0.45

## CONICAL POINTS

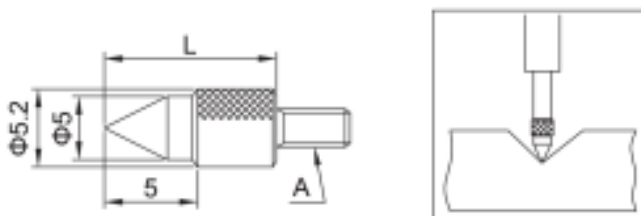

Code	Material	Tip angle	L(mm)	A
6282-0601	Steel	60°	10	M2.5X0.45
6282-0602	Steel	60°	12.7	#4-48UNF

## CONICAL POINTS

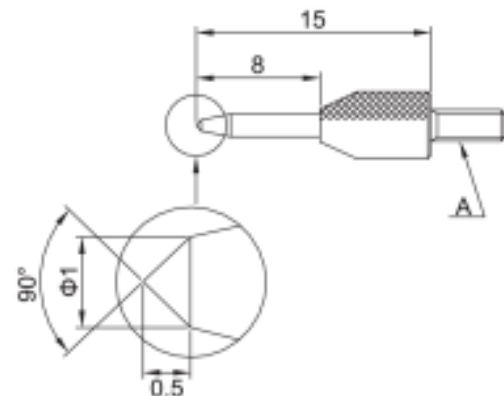

Code	Material	A
6282-0901	Steel	M2.5X0.45

## NEEDLE POINTS

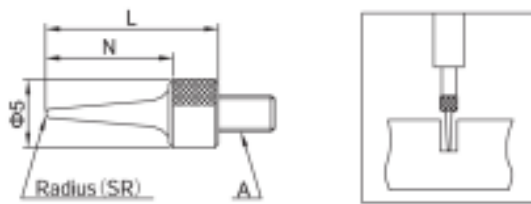

Code	Material	N(mm)	L(mm)	SR(mm)	A
6282-1601	Steel	11	15	0.4	M2.5X0.45
6282-1602	Steel	13	17	0.2	M2.5X0.45
6282-1603	Steel	21	25	0.4	M2.5X0.45
6282-1604	Steel	31	35	0.4	M2.5X0.45

## FLAT POINTS

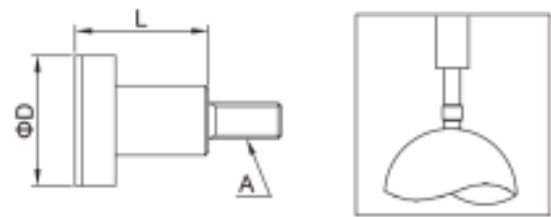

Code	Material	$\Phi D$ (mm)	L(mm)	A
6282-1201	Steel	10	10	M2.5X0.45
6282-1202	Steel	15	10	M2.5X0.45
6282-1203	Steel	20	10	M2.5X0.45
6282-1204	Steel	25	10	M2.5X0.45
6282-1205	Steel	30	10	M2.5X0.45
6282-1206	Steel	12.7	9.53	#4-48UNF
6282-1207	Steel	9.53	9.53	#4-48UNF

## KNIFE EDGE POINTS



Code	Material	A
6282-1001	Steel	M2.5X0.45

## FLAT POINTS

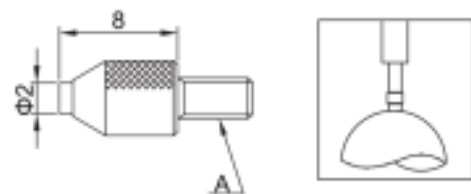

Code	Material	A
6282-1301	Steel	M2.5X0.45

## FLAT POINTS

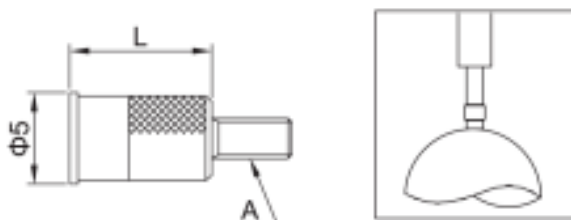

Code	Material	L	A
6282-1101	Steel	8mm	M2.5X0.45
6282-1102	Steel	10mm	M2.5X0.45
6282-1103	Steel	8mm	#4-48UNF

## FLAT POINTS

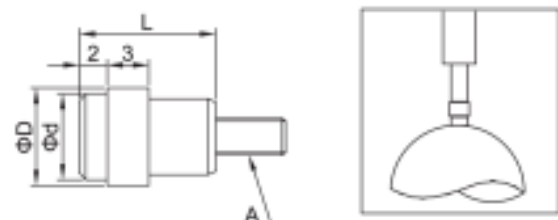

Code	Material	$\Phi D$ (mm)	$\Phi d$ (mm)	L(mm)	A
6282-1501	Steel	7	6.4	10	M2.5X0.45
6282-1502	Steel	9	8	10	M2.5X0.45

## FLAT POINTS

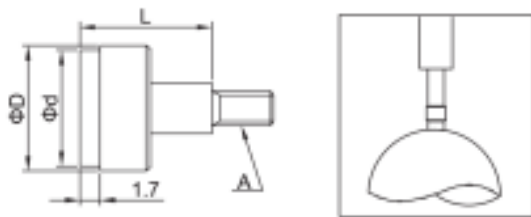

Code	Material	ΦD(mm)	Φd(mm)	L(mm)	A
6282-1401	Steel	5.2	4.3	5	M2.5X0.45
6282-1402	Steel	7	6.5	10	M2.5X0.45
6282-1403	Steel	10.5	9.5	10	M2.5X0.45
6282-1404	Steel	17	15	10	M2.5X0.45
6282-1405	Steel	22	20	10	M2.5X0.45
6282-1406	Steel	27	25	10	M2.5X0.45
6282-1407	Steel	32	30	10	M2.5X0.45

## ROLLER POINTS

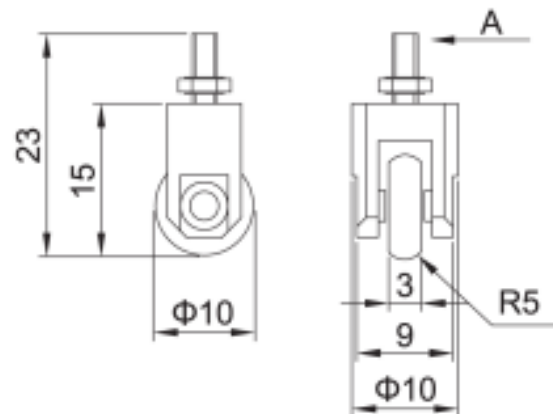

Code	Material	A
6282-1901	Steel	M2.5X0.45
6282-1902	Steel	#4-48UNF

## EXTENSION RODS



Code	Material	L	A
6282-2001	Steel	10mm	M2.5X0.45
6282-2002	Steel	15mm	M2.5X0.45
6282-2003	Steel	20mm	M2.5X0.45
6282-2004	Steel	25mm	M2.5X0.45
6282-2005	Steel	30mm	M2.5X0.45
6282-2006	Steel	35mm	M2.5X0.45
6282-2007	Steel	40mm	M2.5X0.45
6282-2008	Steel	45mm	M2.5X0.45
6282-2009	Steel	50mm	M2.5X0.45
6282-2010	Steel	55mm	M2.5X0.45
6282-2011	Steel	60mm	M2.5X0.45
6282-2012	Steel	65mm	M2.5X0.45
6282-2013	Steel	70mm	M2.5X0.45
6282-2014	Steel	75mm	M2.5X0.45
6282-2015	Steel	80mm	M2.5X0.45
6282-2016	Steel	90mm	M2.5X0.45
6282-2017	Steel	100mm	M2.5X0.45
6282-2018	Steel	1"	#4-48UNF
6282-2019	Steel	2"	#4-48UNF
6282-2020	Steel	4"	#4-48UNF

## NEEDLE POINTS

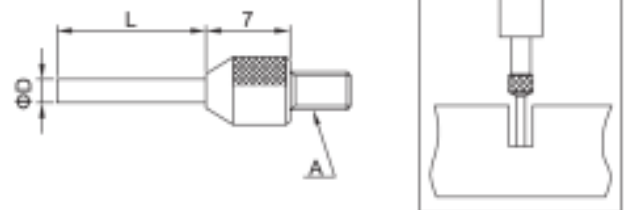

Code	Material	D(mm)	L(mm)	A
6282-1701	Steel	0.45	3	M2.5X0.45
6282-1702	Steel	0.45	5	M2.5X0.45
6282-1703	Carbide	1	3	M2.5X0.45
6282-1704	Carbide	1	5	M2.5X0.45
6282-1705	Carbide	1	8	M2.5X0.45
6282-1706	Carbide	1	10	M2.5X0.45
6282-1707	Carbide	1	20	M2.5X0.45
6282-1708	Carbide	1	40	M2.5X0.45
6282-1709	Carbide	1.5	5	M2.5X0.45
6282-1710	Carbide	1.5	10	M2.5X0.45
6282-1711	Carbide	1.5	13	M2.5X0.45
6282-1712	Carbide	1.5	20	M2.5X0.45
6282-1713	Carbide	1.5	40	M2.5X0.45
6282-1714	Carbide	2	8	M2.5X0.45
6282-1715	Carbide	2	18	M2.5X0.45
6282-1716	Carbide	2	28	M2.5X0.45
6282-1717	Carbide	2	40	M2.5X0.45

## BLADE POINTS

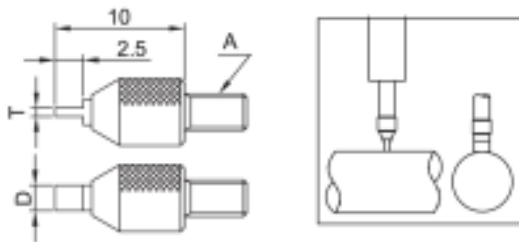

Code	Material	T(mm)	D(mm)	A
6282-1801	Steel	0.4	2	M2.5X0.45
6282-1802	Steel	0.6	2	M2.5X0.45
6282-1803	Steel	1	4	M2.5X0.45

## POINT SET

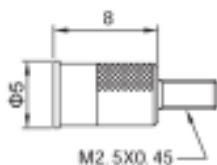

6282-1101

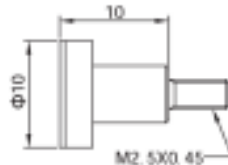

6282-1201

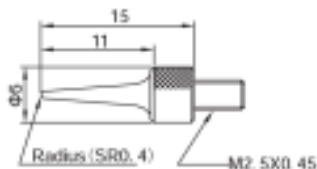

6282-1601

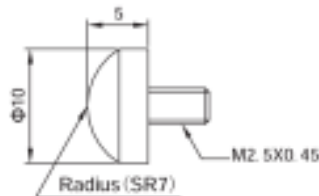

6282-0401

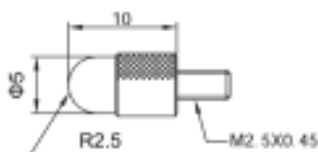

6282-0203

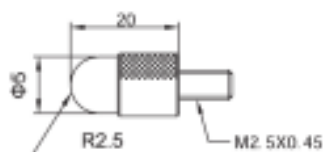

6282-0207

Code	Components	Individual Code
6282-S6	Flat Point	6282-1101
	Flat Point	6282-1201
	Needle Point	6282-1601
	Spherical Point	6282-0401
	Shell Type Point	6282-0203
	Shell Type Point	6282-0207

## LUG BACK FOR DIAL INDICATORS



- Made of aluminum
- Packed in plastic pouch

Code	For dial indicators
7330-L1	2311, 2304
7330-L2	2101, 2102, 2308, 2310, 2309-30, 2314, 2313,
	2318, 2307, 2326-2, 2315, 2326-25, 2325-05,
7330-L3	2325-1
	2312, 2326-3, 2326-4, 2325-2

## FLAT BACK FOR DIAL INDICATORS



- Made of aluminum
- Packed in plastic pouch

Code	For dial indicators
7330-F1	2311, 2304
7330-F2	2101, 2102, 2308, 2310, 2309-30, 2314, 2313,
	2318, 2307, 2326-2, 2315, 2326-25, 2325-05,
7330-F3	2325-1
	2312, 2326-3, 2326-4, 2325-2

## ELECTRONIC DIGITAL TEST INDICATOR

- Ruby contact point, diameter 2mm/0.079"
- Probe length 21.4mm/0.843"
- With tolerance measurement
- Satin-chrome plated brass body
- With two holding stems: 6mm and 8mm, stems 5/32" DIA. and 3/8" DIA. are optional
- With spare battery
- Meet DIN2270
- Packed in plastic box



Code	Range	Resolution
2181-05	+/-0.5mm/0.02"	0.001mm/0.0001"

## DIAL TEST INDICATOR



2381-02



2380-08

Code	Range	Graduation	Bezel diameter
2380-08	0-0.8mm	0.01mm	30mm
2381-08	0-0.8mm	0.01mm	37.5mm
2380-02	0-0.2mm	0.002mm	30mm
2381-02	0-0.2mm	0.002mm	37.5mm
Code	Range	Graduation	Bezel diameter
2380-31	0-0.03"	0.001"	1.18"
2381-31	0-0.03"	0.001"	1.48"
2380-35	0-0.03"	0.0005"	1.18"
2381-35	0-0.03"	0.0005"	1.48"
2380-301	0-0.008"	0.0001"	1.18"
2381-301	0-0.008"	0.0001"	1.48"

- Jeweled bearing, shock-proof
- Carbide contact point, diameter 2mm/0.079", supplied with wrench
- Probe length 13.5mm/0.53"
- With two holding stems: metric 4mm and 8mm, inch 5/32" DIA. and 3/8" DIA.
- Satin-chrome finish brass body, anti magnetic
- Meet DIN2270
- Packed in plastic box

## LONG PROBE DIAL TEST INDICATOR



- Jeweled bearing, shock-proof
- Carbide contact point, diameter 2mm/0.079", supplied with wrench
- Probe length: metric 46.4mm, inch 1.74"
- With two holding stems: metric 4mm and 8mm, inch 5/32" DIA. and 3/8" DIA.
- Satin-chrome finish brass body, anti magnetic
- Meet DIN2270
- Packed in plastic box

Code	Range	Graduation	Bezel diameter
2382-08	0-0.8mm	0.01mm	30mm
2383-08	0-0.8mm	0.01mm	37.5mm
Code	Range	Graduation	Bezel diameter
2382-03	0-0.03"	0.0005"	1.18"
2383-03	0-0.03"	0.0005"	1.48"

## DUAL GRADUATION DIAL TEST INDICATOR



- Jeweled bearing, shock-proof
- Carbide contact point, diameter 0.08"/2mm, supplied with wrench
- Probe length 0.53"/13.5mm
- With two holding stems: 5/32" DIA. and 3/8" DIA.
- Satin-chrome finish brass body, anti magnetic
- Packed in plastic box

Code	Range	Graduation	Bezel diameter
2387-03	0-0.03"/0-0.6mm	0.0005"/0.01mm	1.48"/37.5mm

## PRECISION DIAL TEST INDICATOR



- Jeweled bearing, shock-proof
- Ruby contact point, diameter 2mm
- Probe length 16mm
- With two holding stems: 4mm and 8mm
- Satin-chrome finish brass body, antimagnetic
- Meet DIN2270
- Packed in plastic box

Code	Range	Graduation	Bezel diameter
2384-012	0-0.12mm	0.001mm	31mm
2388-012	0-0.12mm	0.001mm	38.4mm

## LARGE RANGE DIAL TEST INDICATOR



- Steel contact point, diameter 2mm/0.079"
- Probe length 16mm/0.630"
- Holding stem: metric 4mm, inch 5/32" DIA.
- Meet DIN2270
- Packed in plastic box

Code	Range	Graduation	Bezel diameter
2386-16	+/-1.6mm	0.01mm	38.4mm
Code	Range	Graduation	Bezel diameter
2386-006	+/-0.06"	0.0005"	1.51"

## CONTACT POINT FOR DIAL TEST INDICATOR

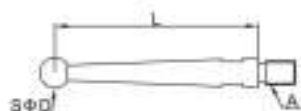

- Suitable for dial test indicators code no. 2380, 2381 and 2387

Code	Material	L(mm)	A	D(mm)
6284-1	Steel	13.5	M1.6X0.2	1
6284-2	Steel	13.5	M1.6X0.2	2
6284-3	Carbide	13.5	M1.6X0.2	2
6284-4	Ruby	13.5	M1.6X0.2	2
6284-5	Steel	13.5	M1.6X0.2	3

## TEST INDICATOR HOLDER



6293-1 and 6293-3



6293-2

- Packed in plastic pouch

Code	Stem section	Stem length	Clamp holes
6293-1	9x9mm	100mm	Ø4mm and Ø8mm
6293-2	Ø8mm	115mm	Ø4mm and Ø8mm
6293-3	0.25x0.5"	4"	5/32" DIA. and 3/8" DIA.

## TEST INDICATOR HOLDER

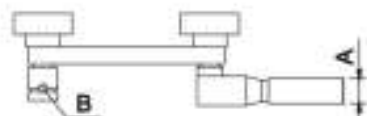

- Packed in plastic pouch

Code	Size A	Size B
6291-1	Ø8mm	Ø4mm
6291-2	Ø1/4"	5/32" DIA.

## UNIVERSAL TEST INDICATOR HOLDER



- Set the indicator at a desired position
- Packed in plastic pouch

Code	Stem
6293-4	Ø8mm
6293-5	0.25" DIA.

## LINEAR GAGE

- Measuring force less than 0.63N
- With linear ball bearing
- Packed in carton



Code	Range	Stroke
7103	+/-2mm(+/-0.1")	4.3mm/0.17"

## COUNTER

- Digital and analog display
- 6 analog resolutions
- Buttons: power on/off, gage calibration, data set, tolerance set, mm/inch conversion absolute and relative measurement, data hold, boolean calculation
- Automatic power off
- RS232 output
- Packed in aluminum box



Code	Accept linear gage	Digital resolution	Display range
7104	1pc	0.1 m	+/-2000 m
7104-E	2pcs	5 in	+/-100000 in

## LINEAR GAGE WITH COUNTER

- Including: counter, linear gage, pedal switch, SPC connection cable, AC/DC adapter, software, batteries, screwdriver, spanner
- Packed in aluminum box



Code	Unit	Counter	Linear gage
7105	m	7104	7103 (1pc)
7105-E	in	7104-E	7103 (2pcs)

## MAGNETIC STAND

- Main stem:  $\text{Ø}12 \times 176 \text{mm}$  (0.5x7")
- Assistant stem:  $\text{Ø}10 \times 160 \text{mm}$  (0.4x6.4")
- Clamp hole 3/8" DIA. with  $\text{Ø}8 \text{mm}$  sleeve
- For dial indicators with lug back or flat back
- Base:  $60 \times 50 \times 55 \text{mm}$  (2.4x2x2.2") with on/off switch
- Packed in carton

Code	Magnetic force
6200-60	60kgf/132lbf



## MAGNETIC STAND

- With fine adjustment
- Main stem:  $\text{Ø}12 \times 176 \text{mm}$  (0.5x7")
- Assistant stem:  $\text{Ø}10 \times 160 \text{mm}$  (0.4x6.4")
- Clamp hole 3/8" DIA. with  $\text{Ø}8 \text{mm}$  sleeve
- For dial indicators with lug back or flat back
- Base:  $60 \times 50 \times 55 \text{mm}$  (2.4x2x2.2") with on/off switch
- Packed in carton

Code	Magnetic force
6201-60	60kgf/132lbf



## HEAVY DUTY MAGNETIC STAND

- With fine adjustment
- Clamp hole 3/8" DIA. with  $\text{Ø}8 \text{mm}$  sleeve
- For dial indicators with lug back or flat back
- Magnetic base with on/off switch
- Packed in carton



Code	Magnetic force	Main stem	Assistant stem	Base
6202-80	80kgf/176lbf	$\text{Ø}16 \times 225 \text{mm}$ (0.6x8.9")	$\text{Ø}12 \times 190 \text{mm}$ (0.5x7.5")	$60 \times 50 \times 55 \text{mm}$ (2.4x2x2.2")
6202-100	100kgf/220lbf	$\text{Ø}20 \times 360 \text{mm}$ (0.8x14.2")	$\text{Ø}12 \times 220 \text{mm}$ (0.5x8.7")	$73 \times 50 \times 55 \text{mm}$ (2.9x2x2.2")

## HEAVY DUTY MAGNETIC STAND

- With fine adjustment
- Clamp hole 3/8" DIA. with Ø8mm sleeve
- For dial indicators with lug back or flat back
- Magnetic base with on/off switch
- Packed in carton



Code	Magnetic force	Main stem	Assistant stem	Branch stem	Base
6220-80	80kgf/176lbf	Ø20x170mm(0.8x6.7")	Ø14x170mm(0.6x6.7")	Ø10x127mm(0.4x5")	60x50x55mm(2.4x2x2.2")
6220-100	100kgf/220lbf	Ø20x400mm(0.8x15.8")	Ø16x360mm(0.6x14.2")	Ø12x150mm(0.5x6")	73x50x55mm(2.9x2x2.2")

## MAGNETIC STAND

- With fine adjustment
- Clamp hole 3/8" DIA. with Ø8mm sleeve
- Magnetic base with on/off switch
- Packed in carton



Code	Magnetic force	Main stem	Assistant stem	Base
6203-60	60kgf/132lbf	Ø16x230mm(0.6x9.1")	Ø16x230mm(0.6x9.1")	70x46x60mm(2.8x1.8x2.4")
6203-80	80kgf/176lbf	Ø20x412mm(0.8x16.2")	Ø16x230mm(0.6x9.1")	75x60x80mm(3x2.4x3.1")

## UNIVERSAL MAGNETIC STAND

- Overall stem length 340mm/13.4"
- Dovetail groove for test indicator
- Clamp hole 3/8" DIA. with Ø8mm sleeve
- With fine adjustment
- Base: 60x50x55mm(2.4x2x2.2"), with on/off switch
- Packed in carton

Code	Magnetic force
6208-80	80kgf/176lbf



## HEAVY DUTY UNIVERSAL MAGNETIC STAND

- Overall stem length 340mm/13.4"
- Dovetail groove for test indicators
- Clamp hole 3/8" DIA. with Ø8mm sleeve
- With fine adjustment
- Base: 60x50x55mm (2.4x2x2.2"), with on/off switch
- Packed in carton

Code	Magnetic force
6205-80	80kgf/176lbf



## FLEX ARM MAGNETIC STAND

- Overall arm length 330mm/13"
- Accept dial indicators with stem Ø8mm and 3/8" DIA.
- Base: 60x50x55mm (2.4x2x2.2"), with on/off switch
- Packed in carton

Code	Magnetic force
6207-80	80kgf/176lbf



## MAGNETIC STAND FOR UNEVEN SURFACE

- Attached on any shape or contour
- With fine adjustment
- Main stem: Ø12x176mm (0.5x6.9")
- Assistant stem: Ø10x160mm (0.4x6.3")
- Clamp hole 3/8" DIA. with Ø8mm sleeve
- For dial indicator with lug back or flat back
- Packed in carton

Code
6215-60



## VACUUM STAND

- To be used on granite plates or other smooth surfaces
- Aluminum base, diameter 80mm/3.1"
- With on/off switch
- Dovetail groove for test indicators
- Clamp hole 3/8" DIA. with Ø8mm sleeve
- With fine adjustment
- Packed in carton

Code

6217



## UNIVERSAL STAND

- Main stem: Ø14x200mm (0.6x7.9")
- Assistant stem: Ø12x270mm (0.5x10.6")
- Base: 220x58x35mm (8.7x2.3x1.4")
- Clamp hole 3/8" DIA. with Ø8mm sleeve
- With fine adjustment
- Packed in carton

Code

6214



## SMALL MAGNETIC STAND

- Main stem:  $\varnothing 7.8 \times 102 \text{mm}$  (0.31 x 4")
- Assistant stem:  $\varnothing 6.7 \times 113 \text{mm}$  (0.26 x 4.4")
- Base:  $55 \times 37 \times 52 \text{mm}$  (2.2 x 1.5 x 2")
- With steel plate to isolate magnet
- For dial indicators with lug back
- Packed in carton

Code	Magnetic force
6213-25	25kgf/55lbf



## MINI MAGNETIC STAND

- For dial test indicators
- Overall stem length 170mm/6.7"
- Dovetail groove
- Clamp hole 3/8" DIA. with  $\varnothing 8 \text{mm}$  sleeve
- With fine adjustment
- Base:  $36 \times 30 \times 35 \text{mm}$  (1.4 x 1.2 x 1.4"), with on/off switch
- Packed in carton

Code	Magnetic force
6204-40	40kgf/88lbf



## MINI MAGNETIC STAND

- For dial test indicators
- Overall stem length 180mm/7.1"
- Dovetail groove
- Clamp hole 3/8" DIA. with  $\varnothing 8 \text{mm}$  sleeve
- With fine adjustment
- Base:  $30 \times 30 \times 30 \text{mm}$  (1.2 x 1.2 x 1.2"), with on/off push button
- Packed in carton

Code	Magnetic force
6223-18	18kgf/40lbf

